

WCR4000-Series

Roller Cassette Torque Wrench

**One of the most
versatile and
high performing
limited access
tools.**



WCR-Series, Roller Cassette Torque Wrench

▼ WCR4000 Roller Cassette with Spanner and W4000 Drive Unit



Resolves bolt to pipe & bolt height restrictions

- Provides a safe and reliable controlled bolting solution for flanges with limited access
- Spanners available to fit most commonly used API flanges
- Small nose radius – resolves bolt to pipe restrictions
- Slim spanner design – reduces bolt height restrictions
- Wide range of spanners ranging from 36 - 80 mm (1⁷/₁₆ - 3¹/₈ inch)
- Includes handle to improve tool handling and safety
- Rigid steel body for maximum endurance and minimum downtime.



SAFE LINK Design

SAFE-LINK spanner design includes a mechanical fuse inside the cassette, providing a safer bolting experience for the operator and bystanders.



Closed Bi-Hex Spanner

Slim ring style profile with bi-hexagonal design provides the ultimate mixture of versatility and durability.

▼ The small nose radius of the closed spanner resolves bolt to pipe restrictions where standard hexagon cassettes do not fit.



▼ The slim closed spanner design allows tool location between bolts where access is restricted and standard hexagon cassettes do not fit.



▼ The WCR-wrench must be removed and repositioned after each wrench cycle by operating the pump in the retract direction. The tool contains no spring return.

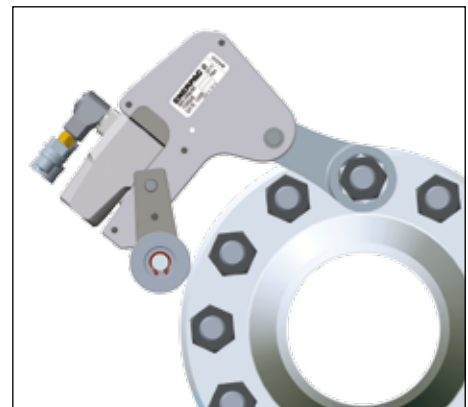

Hydraulic Roller Cassette Torque Wrench



WCR4000-Series Applications

The WCR4000 helps resolve narrow clearance restrictions in bolting of API and BOP flanges.

The Enerpac WCR4000 Roller Cassette has been developed for applications where there are severe clearance restrictions, particularly in height above the nut or between the bolt center and the inside of the joint.

Powered by the standard W4000 drive unit which is compatible with standard W-Series hexagon cassettes.

The WCR-wrench must be removed and repositioned after each wrench cycle by operating the pump in the retract direction. The tool contains no spring return.

Rigid Steel Design

The most advanced and safe torque wrenches on the market. To ensure that the tools you buy meet our own exacting requirements, during the design process every prototype was put through finite element stress analysis, photo-elastic modeling, rigorous cyclic testing and strain gauging.

Steel tool body for maximum endurance and minimum downtime.

WCR Series



Bi-Hexagonal Spanner Size:

36 - 80 mm, 1⁷/₁₆ - 3¹/₈"

Spanner Nose Radius:

31 - 55 mm

Maximum Torque:

5762 Nm (4250 Ft.lbs)

Maximum Operating Pressure:

700 bar

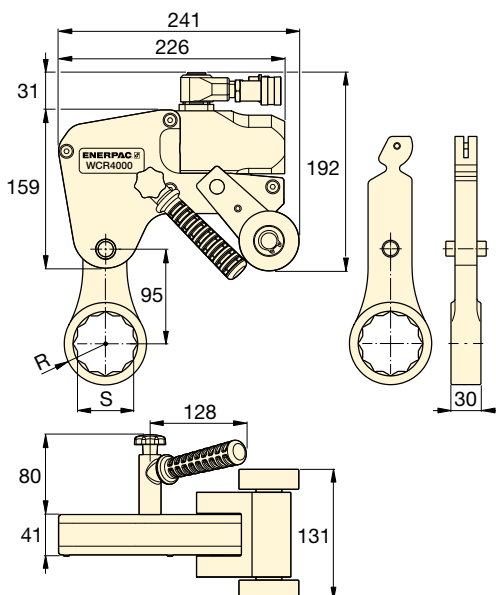

Torque Wrench Pumps

Visit enerpac.com for system matched air and electric torque wrench pumps providing control to operate hydraulic torque

wrenches.



Torque Wrench Hoses

Use Enerpac THQ-700 Series torque wrench hoses with W-Series torque wrenches to ensure the integrity of your hydraulic system.

hydraulic system.

6 m long, 2 hoses

THQ-706T

12 m long, 2 hoses

THQ-712T

Closed Spanner Hexagon Size S		Closed Spanner Model Number	Maximum Torque (Nm)	Spanner Radius R (mm)	Spanner Weight * (kg)	Roller Cassette Assembly Model Nr.	Drive Unit Model Nr.
(inch)	(mm)						
1 ⁷ / ₁₆	36	W4107CS	5762	31	1,9	WCR4000	W4000
1 ¹ / ₂	38	W4108CS	5762	33	2,0		
1 ⁵ / ₈	41	W4110CS	5762	33	1,9		
1 ¹³ / ₁₆	46	W4113CS	5762	36	1,9		
1 ⁷ / ₈	48	W4114CS	5762	38	2,1		
2	50	W4200CS	5762	38	1,9		
2 ³ / ₁₆	55	W4203CS	5762	41	2,0		
2 ³ / ₈	60	W4206CS	5762	45	2,1		
2 ⁹ / ₁₆	65	W4209CS	5762	47	2,1		
2 ³ / ₄	70	W4212CS	5762	50	2,1		
2 ¹⁵ / ₁₆	75	W4215CS	5762	52	2,1		
3 ¹ / ₈	80	W4302CS	5762	55	2,2		

* Spanner weight. For total weight add 6,3 kg for WCR4000 and 2,0 kg for W4000.

▼ Powered by the standard W4000 drive unit which is compatible with standard W-Series hexagon cassettes.

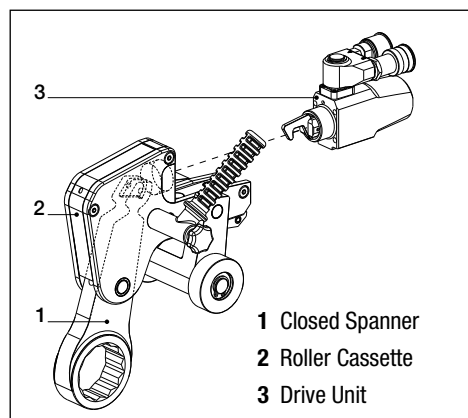

WCR-Series, Roller Cassette Torque Wrench



The Industrial Tools Line

Cylinders and Lifting Products

- General Purpose
- Aluminium Lightweight
- Pancake
- Flat-Jac®, Low Height
- Pull
- Hollow Plunger
- Precision
- Long Stroke
- High Tonnage
- POWR'RISER® Lifting Jacks
- Jacks
- Cylinder-Pump Sets

Pumps

- Manual
- Cordless & Electric Driven
- Compressed Air Driven
- Petrol Driven

System Components

- Hoses, Couplers, Oil
- Gauges, Adaptors
- Manifolds, Fittings

Valves

- 3-and 4-Way Directional
- Pressure and Flow Control

Presses

- Bench, Workshop, Roll Frame
- Arbor and C-Clamps
- Tension Meters, Load Cells

Pullers

- Master Pullers Sets
- Multi Purpose Puller Sets
- Posi Lock® Pullers

Tools

- Maintenance Sets
- Punches
- Machine Lifts
- Load Skates
- Cutters
- Pipe Benders
- Wedgie, Spreaders

Bolting Tools

- Multipliers
- Torque Wrenches
- Impact Sockets
- Bolt Tensioners
- Wrench and Tensioner Pumps
- Flange Alignment Tools
- Flange Facing Tool
- Nut Splitters

Integrated Solutions

- Synchronous Lifting Systems
- Stage Lifting Systems
- Synchronous Hoisting Systems
- Hydraulic Gantries
- Strand Jacks
- Skidding Systems

Enerpac Worldwide Locations

For a complete list of addresses see www.enerpac.com or eMail: info@enerpac.com

About Enerpac

Enerpac is the leading global provider of high-pressure hydraulic tools and solutions with a broad range of products, local expertise and worldwide distribution network. With a proven track record in a wide range of markets, Enerpac designs and manufactures high-quality tools and solutions for all industrial applications.

For latest Enerpac information: www.enerpac.com

- Online Bolting Calculator
- Learn more about hydraulics
- Promotions
- New products
- Electronic Catalogues
- Trade shows
- Manuals (instruction and repair sheets)
- Nearest Distributors & Service Centers
- Enerpac products in action
- Integrated Solutions.



Enerpac Bolting Van

The Enerpac Bolting Service offers full bolting tool service and maintenance wherever you need it.

- Demonstrate Enerpac Bolting Tools on your premises.
- Repair and calibrate all Bolting Tool brands.
- Training for the safe and efficient use of Bolting Tools.

Enerpac has gained unique experience in delivering hydraulic solutions for the controlled movement and positioning of heavy objects. Enerpac supports your business by offering the right solutions and service to help you get your work done efficiently and safely.

Ordering Products and Catalogues

To find the name of the closest Enerpac distributor or service center, to request literature or technical application assistance, contact Enerpac at one of the addresses on www.enerpac.com or pose your question through E-mail: info@enerpac.com



Enerpac Academy

Enerpac Academy is our in-house training centre, set up exclusively for Enerpac business partners, Enerpac users and Enerpac employees: training programs ranging from tool expertise, repairs and maintenance, to safe operation of high-pressure hydraulic tools.

Your Enerpac Distributor: