

NOTES:

LEGEND

- ▲ Control Station
- ▽ Water Stop Valve
- 600 Valve
- Lamp Post
- TP Telephone Pole
- ME Roadside Eye
- MP Marker Post
- B Bollard
- RG Road Gully
- RWP/RM Water drainage into gully
- NP Marker Post
- IC Inspection Cover
- MC Manhole (Annotated with Cover Level) (C.L.) and Invert Level (I.L.)
- Overhead Telephone Line
- Telephone Line
- Fence

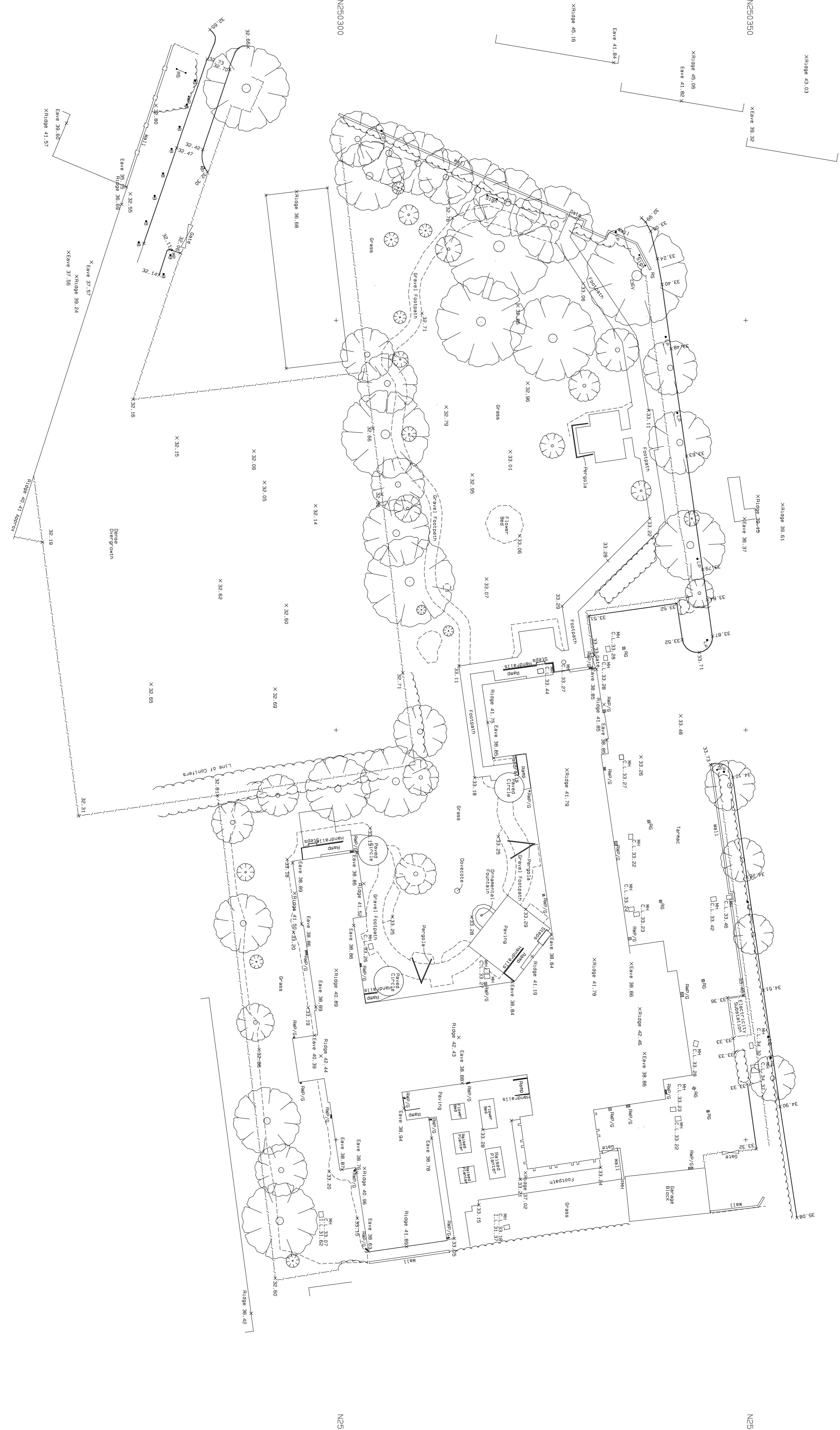
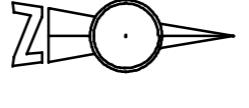

Existing Topography

Project No.:	20110088-01	Date:	9 Jun 2012
Scale:	1:250	Sheet Size:	A1
Drawn:	CW	Scale:	1:250
Checked:	CW	Scale:	1:250

Woods Surveys
 Woods Surveys Ltd, 24 Park Road, Weymouth, Dorset DT9 4LN
 Tel: 01305 375375 Fax: 01305 375376
 Email: info@woods-surveys.com Web: www.woods-surveys.com