

Klein[®]

S I S T E M I

CNC Tooling and Accessories



Partner





With an **experience of over 40 years**, **Sistemi** has become a leading manufacturer of high quality tools for working wood, aluminium and plastics.

The brand **Klein** is synonymous of high quality tools thanks to continuous investment in the use of the latest technology and in training, with a more and more young and dynamic staff, consisting of technicians, designers and trade experts fully available to meet the multiple needs that global competition requires.

Sistemi exports its products today to more than **60 countries** around the world by consolidating its presence by the best retailers in the woodworking field and strengthening its success from year to year in order to start and develop continuously new projects, always with a view to "**customer satisfaction**".

The use of CAD together with an accurate selection of quality raw materials and a careful control performed with high precision instruments ensure the best performance of the tools, ensuring increasing productivity and a highly flexible response to any requests.

25 years of collaboration with the company m. conti have enabled us to offer also a wide range of measuring instruments for the furniture industry.

Since many years already **Sistemi** has become part of  **ACIMALL**, the Association that includes the main Italian manufacturers of machines and tools for woodworking.



CP Tooling & Machinery Ltd.

CP Tooling & Machinery Ltd was set up by Colin Peacock in 2015 to supply innovative, time saving, tooling solutions to the solid timber and panel processing industries throughout the UK.

Colin and his Co. director, Ian Small, have over 70 years-experience in joinery manufacturing and high quality tooling design and sales.

Many end-user manufacturers are already benefitting from our vast knowledge and experience with time and money saving tooling solutions, contact us today to find out how your business could benefit.

CP Tooling & Machinery Ltd.
16 Harelands Court Yard Offices
Moor Road
Melsonby
North Yorkshire
DL10 5NY

Tel. 01748 897170
info@cptooling.co.uk
www.cptooling.co.uk

Index

- Drill Adaptors – 2
- Quick Change Drill Holders – 3
- Dowel Drills – 4 to 8
- Hinge Boring Bits – 9
- Xtra Bore Solid Carbide Dowel Drills – 10
- Solid Carbide Router Cutters for Fibreglass – 11
- CNC Chucks & Collets – 12 to 18
- Tornado Chip & Dust Extracting Clamping Nut – 19
- CNC Chuck Accessories – 20
- Chuck Adapter for Circular Sawblades – 21
- CNC Arbors – 22 to 23
- Spacers – 24
- CNC Chuck Mounting Devices – 25
- CNC Chuck Cleaning Kits – 25
- Solid Carbide Spiral Routers – 26 to 31
- HotBlock Shrink fit Chucks & Devices – 32

Please see the main catalogue KLEIN 14.A for more technical information, or contact us:

Tel. 01748 897170
 Email: colin@cptooling.co.uk
 ian@cptooling.co.uk
 Website: www.cptooling.co.uk

SPURS GEOMETRY OF THE DOWEL DRILLS:

Negative spurs and center point
 ART. L101 ÷ L110

STANDARD

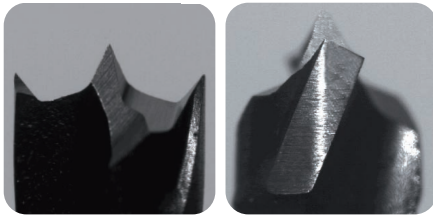

Front Side

- Good finish and tool life
- Lower price

Rounded spurs and center point
 ART. L112 ÷ L113

EXTRA FINE

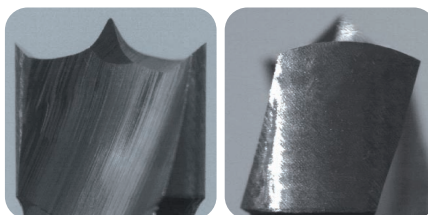

Front Side

- HW more resistant to wear
- Better finish
- Longer tool life

Rounded spurs and reinforced center point
 ART. L114 ÷ L117

EXTRA TIME

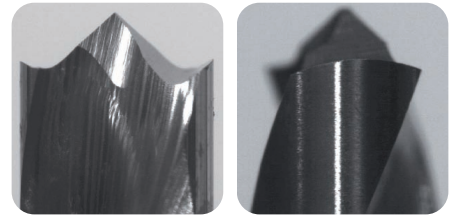

Front Side

- HW more resistant to wear
- Excellent finish
- Longer tool life
- Easier to sharpen
- Excellent performance in any working conditions
- Best price/quality ratio

SOLID CARBIDE ROUTER BITS:

Klein offers a very wide range of solid carbide router bits which can satisfy almost all exigencies by using a CNC machine.

TECHNICAL DATA:

- Tungsten-carbide (Widia) is the most suitable material to use on CNC machines assuring the best performances.
- FLUTE GEOMETRY:

Up Cut style, for a better finish on the bottom of the material

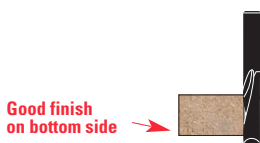

Down Cut Style, for a better finish on the top surface



Compression Style, for a good finish on either top and bottom surface, particularly on laminated materials



- NUMBER OF TEETH:
 - Z=1: allow heavy duties on soft materials and an excellent chip evacuation
 - Z=2: allow a better finish on hard materials and a good chip evacuation
 - Z=3: allow an excellent finish on all types of materials
 - Z=2/Z=3: with chipbreaker, ideal for heavy duties

N.B.: Increasing the number of teeth should increase also the feed speed in order to preserve the tool from burning or early wearing out.

DRILL ADAPTORS

ART. L001 - M10/11x4

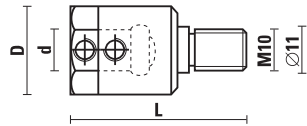

For: MORBIDELLI, BIESSE, WEEKE

RH rotation	LH rotation	d	D	L
L001.100.R	L001.100.L	10	19,5	41

DRILL ADAPTORS

ART. L002 - M10/Taper 30°

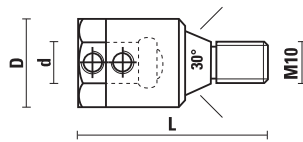

For: VITAP, BUSELLATO, SCHLEICHER

RH rotation	LH rotation	d	D	L
L002.100.R	L002.100.L	10	19,5	46

DRILL ADAPTORS

ART. L003 - M10

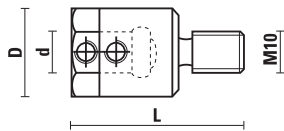

For: AYEN, HOLZMA, MAYER

RH rotation	LH rotation	d	D	L
L003.100.R	L003.100.L	10	19,5	40

QUICK CHANGE DRILL HOLDERS

ART. L031

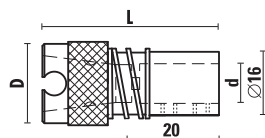

For: MORBIDELLI machines, with pull out spring

Item	d	D	L
L031.500.R	10	20	44

DRILL ADAPTORS

ART. L004 - M8/9x3

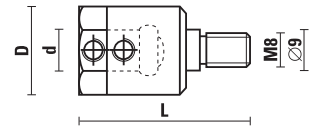

For: MORBIDELLI, NOTTMEYER

RH rotation	LH rotation	d	D	L
L004.100.R	L004.100.L	10	19,5	41

DRILL ADAPTORS

ART. L005 - M8

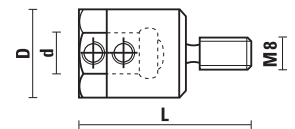

For: NOTTMEYER

RH rotation	LH rotation	d	D	L
L005.100.R	L005.100.L	10	19,5	40

DRILL ADAPTORS

ART. L006 - M8 - 20°48'

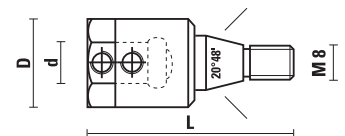

For: BILEK

RH rotation	LH rotation	d	D	L
L006.100.R	L006.100.L	10	19,5	51

ADAPTORS

ART. L031

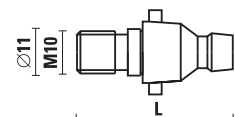

- Adaptor for quick change chucks
 - For: MORBIDELLI, SCM with shank M10/11
 - Use with: Art. L031.100.R and/or Art. L031.500.R

RH rotation	LH rotation	L
L031.600.R	L031.600.L	37

QUICK CHANGE DRILL HOLDERS

ART. L030

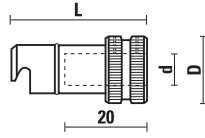

For: **BIESSE**

RH rotation	LH rotation	d	D	L
L030.100.R	L030.100.L	10	20	37

QUICK CHANGE DRILL HOLDERS

ART. L031

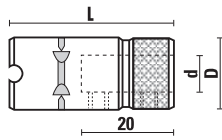

For: **MORBIDELLI**

RH rotation	LH rotation	d	D	L
L031.100.R		10	20	43

QUICK CHANGE DRILL HOLDERS

ART. L032

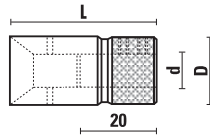

For: **MASTERWOOD, MAGGI, GRIGGIO**

Item	d	D	L
L032.100.R	10	20	40

For: **MINIMAX**

Item	d	D	L
L032.200.R	10	20	40

QUICK CHANGE DRILL HOLDERS

ART. L033

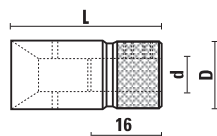

For: **VITAP**

Item	d	D	L
L033.100.R	10	18	42

QUICK CHANGE DRILL HOLDERS

ART. L034

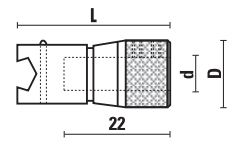

For: **BUSELLATO**

Item	d	D	L
L034.100.R	10	19	34,5

QUICK CHANGE DRILL HOLDERS

ART. L035

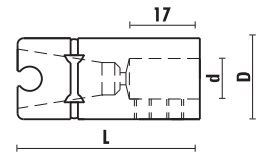

For: **DETEL**

Item	d	D	L
L035.100.R	10	20	45

QUICK CHANGE DRILL HOLDERS

ART. L040

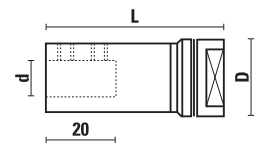

For: **WEEKE**

Item	d	D	L
L040.100.R	10	20	46
L040.101.R	10	20	56
L040.102.R	10	20	66



Z051.314.R

See the main catalogue KLEIN 14.A for more Drill Holders, or contact us:

Tel: 01748 897170

E-Mail: colin@cptooling.co.uk

ian@cptooling.co.uk

Website: www.cptooling.co.uk

HW DOWEL DRILLS Z=2

ART. L103 - L104

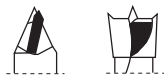
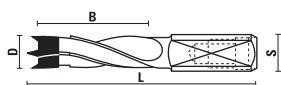

- 4-flutes ($\varnothing 4$ with 2 flutes)
- Spurs ground with negative cutting angle for a good finish
- PTFE-Based coating for a better chip flow
- For natural wood, pressed wood, veneered, chipboard, laminated and MDF

RH rotation	LH rotation	D	B	L	S
L103.040.R	L103.040.L	4	30	57,5	10X20
L103.050.R	L103.050.L	5	30	57,5	10X20
L103.055.R	L103.055.L	5,5	30	57,5	10X20
L103.060.R	L103.060.L	6	30	57,5	10X20
L103.064.R	L103.064.L	6,4	30	57,5	10X20
L103.070.R	L103.070.L	7	30	57,5	10X20
L103.075.R	L103.075.L	7,5	30	57,5	10X20
L103.080.R	L103.080.L	8	30	57,5	10X20
L103.085.R	L103.085.L	8,5	30	57,5	10X20
L103.090.R	L103.090.L	9	30	57,5	10X20
L103.095.R	L103.095.L	9,5	30	57,5	10X20
L103.100.R	L103.100.L	10	30	57,5	10X20
L103.105.R	L103.105.L	10,5	30	57,5	10X20
L103.110.R	L103.110.L	11	30	57,5	10X20
L103.120.R	L103.120.L	12	30	57,5	10X20
L103.127.R	L103.127.L	12,7	30	57,5	10X20
L103.130.R	L103.130.L	13	30	57,5	10X20
L103.140.R	L103.140.L	14	30	57,5	10X20
L103.150.R	L103.150.L	15	30	57,5	10X20
L103.160.R	L103.160.L	16	30	57,5	10X20
L104.040.R	L104.040.L	4	43	70	10X20
L104.050.R	L104.050.L	5	43	70	10X20
L104.055.R	L104.055.L	5,5	43	70	10X20
L104.060.R	L104.060.L	6	43	70	10X20
L104.064.R	L104.064.L	6,4	43	70	10X20
L104.070.R	L104.070.L	7	43	70	10X20
L104.075.R	L104.075.L	7,5	43	70	10X20
L104.080.R	L104.080.L	8	43	70	10X20
L104.082.R	L104.082.L	8,2	43	70	10X20
L104.085.R	L104.085.L	8,5	43	70	10X20
L104.090.R	L104.090.L	9	43	70	10X20
L104.095.R	L104.095.L	9,5	43	70	10X20
L104.100.R	L104.100.L	10	43	70	10X20
L104.105.R	L104.105.L	10,5	43	70	10X20
L104.110.R	L104.110.L	11	43	70	10X20
L104.120.R	L104.120.L	12	43	70	10X20
L104.127.R	L104.127.L	12,7	43	70	10X20
L104.130.R	L104.130.L	13	43	70	10X20
L104.140.R	L104.140.L	14	43	70	10X20
L104.150.R	L104.150.L	15	43	70	10X20



Z051.302.R

On request



Z051.505.R

HW DOWEL DRILLS Z=2

ART. L105 - L106 - L107 - L108

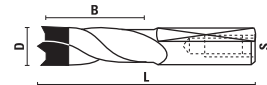

- 2-flutes
- Spurs ground with negative cutting angle for a good finish
- PTFE-Based coating for a better chip flow
- For natural wood, pressed wood, veneered, chipboard, laminated and MDF

RH rotation	LH rotation	D	B	L	S
L105.040.R	L105.040.L	4	27	57,5	10x27
L105.045.R	L105.045.L	4,5	27	57,5	10x27
L105.050.R	L105.050.L	5	27	57,5	10x27
L105.052.R	L105.052.L	5,2	27	57,5	10x27
L105.060.R	L105.060.L	6	27	57,5	10x27
L105.064.R	L105.064.L	6,4	27	57,5	10x27
L105.070.R	L105.070.L	7	27	57,5	10x27
L105.080.R	L105.080.L	8	27	57,5	10x27
L105.082.R	L105.082.L	8,2	27	57,5	10x27
L105.090.R	L105.090.L	9	27	57,5	10x27
L105.095.R	L105.095.L	9,5	27	57,5	10x27
L105.100.R	L105.100.L	10	27	57,5	10x27
L105.110.R	L105.110.L	11	27	57,5	10x27
L105.120.R	L105.120.L	12	27	57,5	10x27
L105.127.R	L105.127.L	12,7	27	57,5	10x27
L105.140.R	L105.140.L	14	27	57,5	10x27
L105.150.R	L105.150.L	15	27	57,5	10x27
L106.050.R	L106.050.L	5	18	57,5	10x34
L106.060.R	L106.060.L	6	18	57,5	10x34
L106.080.R	L106.080.L	8	18	57,5	10x34
L106.100.R	L106.100.L	10	18	57,5	10x34
L107.040.R	L107.040.L	4	35	70	10x30
L107.045.R	L107.045.L	4,5	35	70	10x30
L107.050.R	L107.050.L	5	35	70	10x30
L107.060.R	L107.060.L	6	35	70	10x30
L107.064.R	L107.064.L	6,4	35	70	10x30
L107.070.R	L107.070.L	7	35	70	10x30
L107.080.R	L107.080.L	8	35	70	10x30
L107.090.R	L107.090.L	9	35	70	10x30
L107.095.R	L107.095.L	9,5	35	70	10x30
L107.100.R	L107.100.L	10	35	70	10x30
L107.110.R	L107.110.L	11	35	70	10x30
L107.120.R	L107.120.L	12	35	70	10x30
L107.127.R	L107.127.L	12,7	35	70	10x30
L107.130.R	L107.130.L	13	35	70	10x30
L107.140.R	L107.140.L	14	35	70	10x30
L107.160.R	L107.160.L	16	35	70	10x30
L108.050.R	L108.050.L	5	44	77	10X30
L108.060.R	L108.060.L	6	44	77	10X30
L108.070.R	L108.070.L	7	44	77	10X30
L108.080.R	L108.080.L	8	44	77	10X30
L108.100.R	L108.100.L	10	44	77	10X30
L108.120.R	L108.120.L	12	44	77	10X30



Z051.302.R

On request



Z051.505.R

HW DOWEL DRILLS Z=2

ART. L109

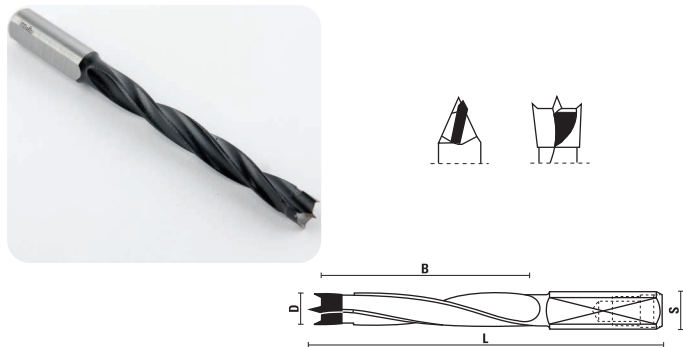

- 4-flutes
- Spurs ground with negative cutting angle for a good finish
- PTFE-Based coating for a better chip flow
- For natural wood, pressed wood, veneered, chipboard, laminated and MDF

RH rotation	LH rotation	D	B	L	S
L109.050.R	L109.050.L	5	45	85	10X30
L109.060.R	L109.060.L	6	45	85	10X30
L109.070.R	L109.070.L	7	45	85	10X30
L109.080.R	L109.080.L	8	45	85	10X30
L109.100.R	L109.100.L	10	45	85	10X30
L109.120.R	L109.120.L	12	45	85	10X30



HW DOWEL DRILLS Z=2

ART. L110

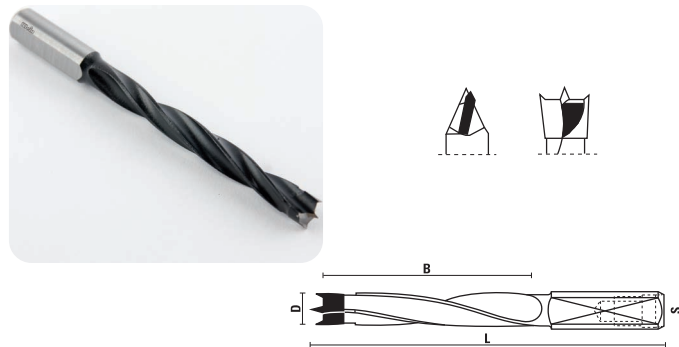

- 4-flutes
- Spurs ground with negative cutting angle for a good finish
- PTFE-Based coating for a better chip flow
- For natural wood, pressed wood, veneered, chipboard, laminated and MDF

RH rotation	LH rotation	D	B	L	S
L110.050.R	L110.050.L	5	65	105	10x30
L110.060.R	L110.060.L	6	65	105	10x30
L110.070.R	L110.070.L	7	65	105	10x30
L110.080.R	L110.080.L	8	65	105	10x30
L110.100.R	L110.100.L	10	65	105	10x30
L110.120.R	L110.120.L	12	65	105	10x30



HW DOWEL DRILLS EXTRA FINE Z=2

ART. L112 - L113

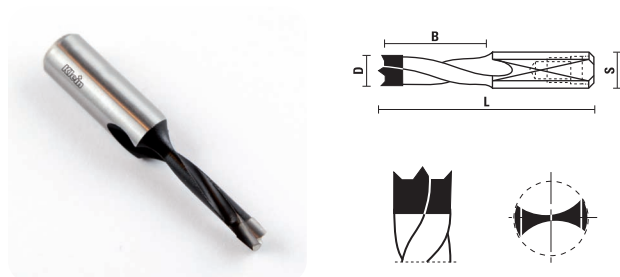

- 2-flutes
- Rounded spurs and special HW for a better finish and longer lasting tool performance
- PTFE-Based coating for a better chip flow
- For natural wood, pressed wood, veneered, chipboard, laminated and MDF

RH rotation	LH rotation	D	B	L	S
L112.050.R	L112.050.L	5	27	57,5	10X27
L112.060.R	L112.060.L	6	27	57,5	10X27
L112.064.R	L112.064.L	6,4	27	57,5	10X27
L112.070.R	L112.070.L	7	27	57,5	10X27
L112.080.R	L112.080.L	8	27	57,5	10x27
L112.100.R	L112.100.L	10	27	57,5	10x27
L112.120.R	L112.120.L	12	27	57,5	10x27

L113.050.R	L113.050.L	5	35	70	10x30
L113.060.R	L113.060.L	6	35	70	10x30
L113.064.R	L113.064.L	6,4	35	70	10x30
L113.070.R	L113.070.L	7	35	70	10x30
L113.080.R	L113.080.L	8	35	70	10x30
L113.100.R	L113.100.L	10	35	70	10x30
L113.120.R	L113.120.L	12	35	70	10x30



DRILL HOLDER-SLEEVES

ART. Z010



For Art. L120

Item	d	D	L	Item	d	D	L
Z010.020.N	2	10	24	Z010.040.N	4	10	24
Z010.025.N	2,5	10	24	Z010.045.N	4,5	10	24
Z010.030.N	3	10	24	Z010.050.N	5	10	24
Z010.032.N	3,2	10	24	Z010.060.N	6	10	24
Z010.035.N	3,5	10	24				

DRILL HOLDERS

ART. Z011

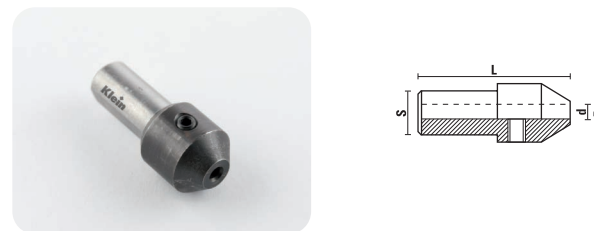

For Art. L120

Item	d	D	L	S	Item	d	D	L	S
Z011.020.N	2	15	35	10x19	Z011.040.N	4	15	35	10x19
Z011.025.N	2,5	15	35	10x19	Z011.045.N	4,5	15	35	10x19
Z011.030.N	3	15	35	10x19	Z011.050.N	5	15	35	10x19
Z011.032.N	3,2	15	35	10x19	Z011.060.N	6	15	35	10x19
Z011.035.N	3,5	15	35	10x19					

HW DOWEL DRILLS EXTRA TIME Z=2

ART. L114 - L115

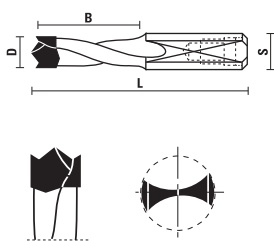

- 2-flutes
- Rounded spurs and reinforced centre point
- Special HW
- Excellent finish and longer tool life
- PTFE-Based coating for a better chip flow
- For natural wood, pressed wood, veneered, chipboard, laminated and MDF
- Suggested also for working trespa and melamine panels

RH rotation	LH rotation	D	B	L	S
L114.050.R	L114.050.L	5	27	57,5	10X27
L114.060.R	L114.060.L	6	27	57,5	10x27
L114.064.R	L114.064.L	6,4	27	57,5	10x27
L114.070.R	L114.070.L	7	27	57,5	10x27
L114.080.R	L114.080.L	8	27	57,5	10x27
L114.100.R	L114.100.L	10	27	57,5	10x27
L114.120.R	L114.120.L	12	27	57,5	10x27
L115.050.R	L115.050.L	5	35	70	10x30
L115.060.R	L115.060.L	6	35	70	10x30
L115.064.R	L115.064.L	6,4	35	70	10x30
L115.070.R	L115.070.L	7	35	70	10x30
L115.080.R	L115.080.L	8	35	70	10x30
L115.100.R	L115.100.L	10	35	70	10x30
L115.120.R	L115.120.L	12	35	70	10x30



Z051.302.R

On request



Z051.505.R

VHW DOWEL DRILLS EXTRA TIME Z=2

ART. L116 - L117

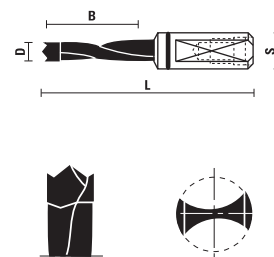

- Solid carbide spiral portion
- 2-flutes
- Rounded spurs and reinforced centre point
- Special HW
- Excellent finish and longer tool life
- For natural wood, pressed wood, veneered, chipboard, laminated and MDF
- Suggested also for working trespa and melamine panels

RH rotation	LH rotation	D	B	L	S
L116.030.R	L116.030.L	3	20	57,5	10X32
L116.040.R	L116.040.L	4	23	57,5	10X27
L116.050.R	L116.050.L	5	23	57,5	10X27
L116.060.R	L116.060.L	6	23	57,5	10X27
L116.064.R	L116.064.L	6,4	23	57,5	10X27
L116.070.R	L116.070.L	7	23	57,5	10X27
L116.080.R	L116.080.L	8	23	57,5	10X27
L117.030.R	L117.030.L	3	20	70	10x38
L117.040.R	L117.040.L	4	30	70	10x30
L117.050.R	L117.050.L	5	30	70	10x30
L117.060.R	L117.060.L	6	30	70	10x30
L117.064.R	L117.064.L	6,4	30	70	10x30
L117.070.R	L117.070.L	7	30	70	10x30
L117.080.R	L117.080.L	8	30	70	10x30



Z051.302.R



Z059.001.L



Z059.001.R

On request



Z051.505.R

VHW DOWEL DRILLS Z=2

ART. L118



- Solid carbide spiral portion
- 2-flutes
- For natural wood, pressed wood, veneered, chipboard, laminated and MDF
- Ideal for Trespa

RH rotation	LH rotation	D	B	L	S
L118.040.R	L118.040.L	4	32	70	10X30
L118.050.R	L118.050.L	5	32	70	10X30
L118.060.R	L118.060.L	6	32	70	10X30
L118.064.R	L118.064.L	6,4	32	70	10X30
L118.070.R	L118.070.L	7	32	70	10X30
L118.080.R	L118.080.L	8	32	70	10X30



Z051.302.R



Z059.001.L



Z059.001.R

On request



Z051.505.R

VHW TWIST DRILLS Z=2

ART. L120



- Solid carbide
- 2-flutes
- For natural wood, pressed wood, veneered, chipboard, laminated and MDF
- Ideal for Trespa
- To use with adaptor bushes Art. Z010/Z011

RH rotation	LH rotation	D	B	L
L120.020.R	L120.020.L	2	18	49
L120.025.R	L120.025.L	2,5	22	55
L120.030.R	L120.030.L	3	22	55
L120.032.R	L120.032.L	3,2	22	55
L120.035.R	L120.035.L	3,5	25	55
L120.040.R	L120.040.L	4	25	55
L120.045.R	L120.045.L	4,5	28	58
L120.050.R	L120.050.L	5	28	58
L120.060.R	L120.060.L	6	28	58

HW THROUGH HOLE DRILL BITS Z=2

ART. L123 - L124 - L125

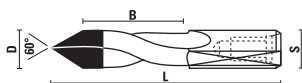

- 2-flutes
- PTFE-Based coating for a better chip flow
- For natural wood, pressed wood, veneered, chipboard, laminated and MDF

RH rotation	LH rotation	D	B	L	S
L123.040.R	L123.040.L	4	27	57,5	10X24
L123.050.R	L123.050.L	5	27	57,5	10X24
L123.060.R	L123.060.L	6	27	57,5	10X24
L123.070.R	L123.070.L	7	27	57,5	10X24
L123.080.R	L123.080.L	8	27	57,5	10X24
L123.090.R	L123.090.L	9	27	57,5	10X24
L123.100.R	L123.100.L	10	27	57,5	10X24
L124.040.R	L124.040.L	4	37	70	10X24
L124.050.R	L124.050.L	5	37	70	10X24
L124.060.R	L124.060.L	6	37	70	10X24
L124.064.R	L124.064.L	6,4	37	70	10X24
L124.070.R	L124.070.L	7	37	70	10X24
L124.080.R	L124.080.L	8	37	70	10X24
L124.090.R	L124.090.L	9	37	70	10X24
L124.095.R	L124.095.L	9,5	37	70	10X24
L124.100.R	L124.100.L	10	37	70	10X24
L124.120.R	L124.120.L	12	37	70	10X24
L125.050.R	L125.050.L	5	45	77	10X24
L125.060.R	L125.060.L	6	45	77	10X24
L125.070.R	L125.070.L	7	45	77	10X24
L125.080.R	L125.080.L	8	45	77	10X24
L125.100.R	L125.100.L	10	45	77	10X24



Z051.302.R

On request



Z051.505.R

HW THROUGH HOLE DRILL BITS Z=2

ART. L126 - L127

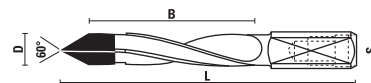

- 4-flutes
- PTFE-Based coating for a better chip flow
- For natural wood, pressed wood, veneered, chipboard, laminated and MDF

RH rotation	LH rotation	D	B	L	S
L126.050.R	L126.050.L	5	27	57,5	10X20
L126.060.R	L126.060.L	6	27	57,5	10X20
L126.080.R	L126.080.L	8	27	57,5	10X20
L127.045.R	L127.045.L	4,5	40	70	10X20
L127.050.R	L127.050.L	5	40	70	10X20
L127.055.R	L127.055.L	5,5	40	70	10X20
L127.060.R	L127.060.L	6	40	70	10X20
L127.070.R	L127.070.L	7	40	70	10X20
L127.080.R	L127.080.L	8	40	70	10X20
L127.090.R	L127.090.L	9	40	70	10X20
L127.100.R	L127.100.L	10	40	70	10X20
L127.120.R	L127.120.L	12	40	70	10X20



Z051.302.R

On request



Z051.505.R

VHW DOWEL DRILLS FOR BOTH RIGHT HAND AND LEFT HAND ROTATION Z=1

ART. L136 - L137

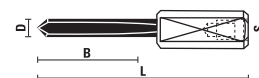

- Solid carbide spiral portion
- Straight cutting edges
- Can be used on either right and left rotation chucks
- Ideal for drilling highly abrasive material

Item	D	B	L	S
L136.020.N	2	12	57,5	10x33
L136.025.N	2,5	15	57,5	10x33
L136.030.N	3	16	57,5	10x30
L136.035.N	3,5	18	57,5	10x30
L136.040.N	4	20	57,5	10x30
L136.050.N	5	25	57,5	10x25
L136.060.N	6	25	57,5	10x25
L136.080.N	8	25	57,5	10x25

L137.020.N	2	12	70	10x33
L137.025.N	2,5	12	70	10x33
L137.030.N	3	24	70	10x30
L137.035.N	3,5	30	70	10x30
L137.040.N	4	32	70	10x30
L137.050.N	5	35	70	10x25
L137.060.N	6	35	70	10x25
L137.080.N	8	35	70	10x25



Z051.302.R

On request



Z051.505.R

VHW THROUGH HOLE DRILL BITS Z=2

ART. L129

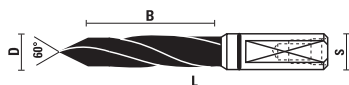

- Solid carbide spiral portion
- 2-flutes
- For natural wood, pressed wood, veneered, chipboard, laminated and MDF
- Best choice when working panels with special coating

RH rotation	LH rotation	D	B	L	S
L129.050.R	L129.050.L	5	30	70	10x30
L129.060.R	L129.060.L	6	30	70	10x30
L129.080.R	L129.080.L	8	30	70	10x30



Z051.302.R



Z059.001.L



Z059.001.R

On request



Z051.505.R

HW DOWEL DRILLS WITH COUNTERSINK Z=2

ART. L138 - L139

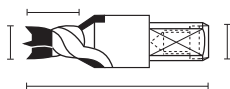

- Spurs ground with negative cutting angle for a good finish
- Cylindrical shank with flat/screw

RH rotation	LH rotation	D	B	L	S
L138.080.R	L138.080.L	8	12	57,5	10x20
L138.081.R	L138.081.L	8	15	57,5	10x20
L138.082.R	L138.082.L	8	20	57,5	10x20
L138.100.R	L138.100.L	10	12	57,5	10x20
L138.101.R	L138.101.L	10	15	57,5	10x20
L138.102.R	L138.102.L	10	20	57,5	10x20

L139.080.R	L139.080.L	8	12	70	10x20
L139.081.R	L139.081.L	8	15	70	10x20
L139.082.R	L139.082.L	8	20	70	10x20
L139.100.R	L139.100.L	10	12	70	10x20
L139.101.R	L139.101.L	10	15	70	10x20
L139.102.R	L139.102.L	10	20	70	10x20



Z051.302.R

HW COUNTERSINKS Z=2 - 90°

ART. L130



- For 4 Flutes drills:
Articles L103, L104, M101, M102, M103, M121, M122, M123, N101, N111, N135, N136
- Adjustable on the cutting length

RH rotation	LH rotation	d	D
L130.040.R	L130.040.L	4	15,5
L130.050.R	L130.050.L	5	15,5
L130.060.R	L130.060.L	6	15,5
L130.064.R	L130.064.L	6,4	15,5
L130.070.R	L130.070.L	7	18
L130.080.R	L130.080.L	8	18
L130.090.R	L130.090.L	9	18
L130.100.R	L130.100.L	10	20
L130.120.R	L130.120.L	12	22

HW COUNTERSINKS Z=2 - 90°

ART. L131

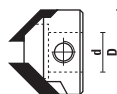

- For Articles L105, L106, L107, L108
- To be mounted on the shank Ø 10

RH rotation	LH rotation	d	D
L131.100.R	L131.100.L	5/10	20
L131.120.R	L131.120.L	11/12	22



Z051.304.R

HW THROUGH HOLE DRILL BITS "E.T." LINE Z=2

ART. L132 - L133

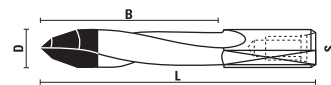

- **High performance**, double angle geometry
- PTFE-Based coating for a better chip flow
- For natural wood, pressed wood, veneered, chipboard, laminated and MDF

RH rotation	LH rotation	D	B	L	S
L132.050.R	L132.050.L	5	30	58	10x24
L132.060.R	L132.060.L	6	30	58	10x24
L132.080.R	L132.080.L	8	30	58	10x24

L133.040.R	L133.040.L	4	36	70	10x24
L133.050.R	L133.050.L	5	36	70	10x24
L133.060.R	L133.060.L	6	36	70	10x24
L133.064.R	L133.064.L	6,4	36	70	10x24
L133.070.R	L133.070.L	7	36	70	10x24
L133.080.R	L133.080.L	8	36	70	10x24
L133.100.R	L133.100.L	10	36	70	10x24
L133.120.R	L133.120.L	12	36	70	10x24



Z051.302.R

On request



Z051.505.R

VHW THROUGH HOLE DRILL BITS "E.T." LINE Z=2

ART. L134 - L135

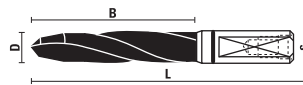

- **Solid carbide spiral portion**
- **High performance**, double angle geometry
- For natural wood, pressed wood, veneered, chipboard, laminated and MDF

RH rotation	LH rotation	D	B	L	S
L134.050.R	L134.050.L	5	28	58	10x20
L134.060.R	L134.060.L	6	28	58	10x20
L134.080.R	L134.080.L	8	28	58	10x20

L135.040.R	L135.040.L	4	40	70	10x20
L135.050.R	L135.050.L	5	40	70	10x20
L135.060.R	L135.060.L	6	40	70	10x20
L135.064.R	L135.064.L	6,4	40	70	10x20
L135.070.R	L135.070.L	7	40	70	10x20
L135.080.R	L135.080.L	8	40	70	10x20



Z051.302.R



Z059.001.L



Z059.001.R

On request



Z051.505.R

HW HINGE BORING BITS Z=2+2

ART. L140 - L141

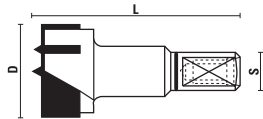

For natural and pressed woods, chipboards, veneered and laminate coated panels and MDF

RH rotation	LH rotation	D	L	S
L140.150.R	L140.150.L	15	57	10X26
L140.160.R	L140.160.L	16	57	10X26
L140.170.R	L140.170.L	17	57	10X26
L140.180.R	L140.180.L	18	57	10X26
L140.190.R	L140.190.L	19	57	10X26
L140.200.R	L140.200.L	20	57	10X26
L140.220.R	L140.220.L	22	57	10X26
L140.240.R	L140.240.L	24	57	10X26
L140.250.R	L140.250.L	25	57	10X26
L140.260.R	L140.260.L	26	57	10X26
L140.280.R	L140.280.L	28	57	10X26
L140.300.R	L140.300.L	30	57	10X26
L140.320.R	L140.320.L	32	57	10X26
L140.340.R	L140.340.L	34	57	10X26
L140.350.R	L140.350.L	35	57	10X26
L140.360.R	L140.360.L	36	57	10X26
L140.380.R	L140.380.L	38	57	10X26
L140.400.R	L140.400.L	40	57	10X26

L141.150.R	L141.150.L	15	70	10X26
L141.160.R	L141.160.L	16	70	10X26
L141.180.R	L141.180.L	18	70	10X26
L141.200.R	L141.200.L	20	70	10X26
L141.220.R	L141.220.L	22	70	10X26
L141.250.R	L141.250.L	25	70	10X26
L141.260.R	L141.260.L	26	70	10X26
L141.300.R	L141.300.L	30	70	10X26
L141.340.R	L141.340.L	34	70	10X26
L141.350.R	L141.350.L	35	70	10X26
L141.400.R	L141.400.L	40	70	10X26



Z051.302.R



Z059.001.L



Z059.001.R

On request



Z051.505.R

See the main catalogue KLEIN 14.A for more HW Hinge Boring Bits, or contact us:

Tel: 01748 897170

E-Mail: colin@cptooling.co.uk
ian@cptooling.co.uk

Website: www.cptooling.co.uk

VHW HINGE BORING BITS Z=2+2

ART. L155 - L156

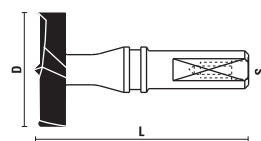

- Solid carbide
- Rounded spurs for an excellent finish
- Highest performance also in extreme conditions
- For high precision bores for hinges
- Ideal for hard and soft wood, chipboard, MDF, veneered and plastic coated boards

RH rotation	LH rotation	D	L	S
L155.150.R	L155.150.L	15	57	10x26
L155.200.R	L155.200.L	20	57	10x26
L155.250.R	L155.250.L	25	57	10x26
L155.300.R	L155.300.L	30	57	10x26
L155.350.R	L155.350.L	35	57	10x26
L156.150.R	L156.150.L	15	70	10x26
L156.200.R	L156.200.L	20	70	10x26
L156.250.R	L156.250.L	25	70	10x26
L156.300.R	L156.300.L	30	70	10x26
L156.350.R	L156.350.L	35	70	10x26



HW HINGE BORING BITS Z=3+3

ART. L143 - L144

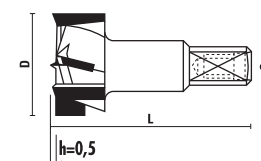

Centerpoint H=0,5 mm

RH rotation	LH rotation	D	L	S
L143.250.R	L143.250.L	25	57,5	10x26
L143.260.R	L143.260.L	26	57,5	10x26
L143.300.R	L143.300.L	30	57,5	10x26
L143.350.R	L143.350.L	35	57,5	10x26
L143.400.R	L143.400.L	40	57,5	10x26



Z051.302.R



Without centerpoint

RH rotation	LH rotation	D	L	S
L144.250.R	L144.250.L	25	57,5	10x26
L144.260.R	L144.260.L	26	57,5	10x26
L144.300.R	L144.300.L	30	57,5	10x26
L144.350.R	L144.350.L	35	57,5	10x26



Z051.302.R

VHW DOWEL DRILLS Z=2, "KLEINDIA" COATED

ART. L116.KD - L117.KD

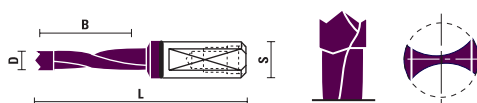

Xtra
bore® Tool life 4 times longer than an uncoated tool

- EXTRA TIME** grinding tool (rounded spurs and reinforced centering point)
- Solid carbide spiral portion (with 2-flutes)
 - Special HW more resistant
 - Excellent finish and longer tool life for excellent performance
 - For natural wood, pressed wood, veneered, chipboard, laminated and MDF
 - Suggested also for working Trespa® and melamine panels

Rh Rot.	Lh Rot.	D	B	L	S
L116.030.RKD NEW	L116.030.LKD NEW	3	20	57,5	10X32
L116.040.RKD NEW	L116.040.LKD NEW	4	23	57,5	10X27
L116.050.RKD NEW	L116.050.LKD NEW	5	23	57,5	10X27
L116.060.RKD NEW	L116.060.LKD NEW	6	23	57,5	10X27
L116.080.RKD NEW	L116.080.LKD NEW	8	23	57,5	10X27
L117.030.RKD NEW	L117.030.LKD NEW	3	20	70	10x38
L117.040.RKD NEW	L117.040.LKD NEW	4	30	70	10x30
L117.050.RKD NEW	L117.050.LKD NEW	5	30	70	10x30
L117.060.RKD NEW	L117.060.LKD NEW	6	30	70	10x30
L117.080.RKD NEW	L117.080.LKD NEW	8	30	70	10x30

VHW THROUGH HOLE DRILL BITS Z=2, "KleinDIA" COATED

ART. L129.KD

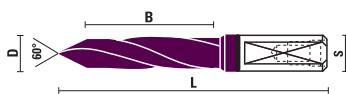

Xtra
bore® Tool life 4 times longer than an uncoated tool

- Solid carbide spiral portion (with 2-flutes)
- Excellent finish and longer tool life
- For natural wood, pressed wood, veneered, chipboard, laminated and MDF
- Best choice when working panels with special coating

Rh Rot.	Lh Rot.	D	B	L	S
L129.050.RKD NEW	L129.050.LKD NEW	5	30	70	10x30

VHW THROUGH HOLE DRILL BITS Z=2 "E.T." LINE, "KleinDIA" COATED

ART. L134.KD - L135.KD



Xtra
bore® Tool life 4 times longer than an uncoated tool

- EXTRA TIME grinding tool (rounded spurs and reinforced centering point)
- Solid carbide spiral portion (with 2-flutes)
- Excellent finish and longer tool life
- High performance thanks to its double angle geometry
- Special HW more resistant
- For natural wood, pressed wood, veneered, chipboard, laminated and MDF

Rh Rot.	Lh Rot.	D	B	L	S
L134.050.RKD NEW	L134.050.LKD NEW	5	28	58	10x20
L134.080.RKD NEW	L134.080.LKD NEW	8	28	58	10x20
L135.040.RKD NEW	L135.040.LKD NEW	4	40	70	10x20
L135.050.RKD NEW	L135.050.LKD NEW	5	40	70	10x20
L135.060.RKD NEW	L135.060.LKD NEW	6	40	70	10x20
L135.080.RKD NEW	L135.080.LKD NEW	8	40	70	10x20

SOLID CARBIDE BITS FOR FIBERGLASS WORKING, KleinDIA® COATED

ART. U130.KD



- For working plastic materials, rubber and fiberglass
- Right-hand rotation
- For routing and shearing
- To be used on portable machines, CNC and routing machines

Item	D	B	L	S	Rot.
U130.030.RKD NEW	3	12	38	3	Rh
U130.040.RKD NEW	4	15	40	4	Rh
U130.050.RKD NEW	5	18	50	5	Rh
U130.060.RKD NEW	6	22	55	6	Rh
U130.080.RKD NEW	8	30	70	8	Rh
U130.100.RKD NEW	10	30	72	10	Rh
U130.120.RKD NEW	12	30	73	12	Rh

KleinDIA®

A surface treatment developed for large-scale production

KleinDIA is a DLC (**Diamond-like Carbon**) anti-friction coating which allows to solve problems of tool abrasion, chip evacuation and chemical attack.

A layer of approx. 1 micron is laid on the tool surface at low temperature, thus not altering the properties of the router bit or knife.

Its high hardness is granted by both Sp2 (**Graphite**) and Sp3 (**Diamond**) carbon hybridisation.

Our several tests confirmed remarkable results on both panel working and solid wood processing.

Working plastic and aluminium without coolant is also possible thanks to a very low friction coefficient.

TECHNICAL FEATURES:

- **High hardness** Hv0,025: 2500-3100
- **Higher wear resistance** (longer working time)
- **Low frictional coefficient** (lowered working temperature)
- **Very low sticking coefficient** (Better chips evacuation)
- **Thickness:** approx. 1 micron
- **Colour:** bright black



KleinDIA is the most advantageous coating, ensuring:

- **Production increase**
- **Better finishing**
- **Less maintenance**

COLLET CHUCKS ISO 30

ART. T118

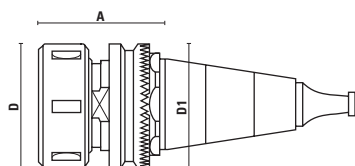

- Supplied with nut (without collet) and retaining pawl

- Threaded nut DIN 6499
- Threaded nut DIN 6388/EOC25

With anti-adherent surface treatment "Impreglon"

- Retaining pawl T118.790.R for:
Morbidelli, SCM

Item	A	D	D1	Spring collets	Clamping nut	Rot.
T118.700.R	55	50	49	Ø 2÷20 (Art. T119/ER32)	Z091.001.R	RH
T118.702.R	55	50	49	Ø 2÷20 (Art. T119/ER32)	Z091.101.R ball bearing nut	RH

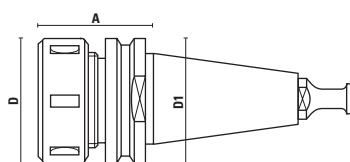

- Retaining pawl T118.891.R for:
Biesse (after 09/09/92), **Masterwood - Bulleri** (motor H.S.D.)

Item	A	D	D1	Spring collets	Clamping nut	Rot.
T118.800.R	50	50	50	Ø 2÷20 (Art. T119/ER32)	Z091.001.R	RH
T118.800.L	50	50	50	Ø 2÷20 (Art. T119/ER32)	Z091.001.L	LH
T118.802.R	50	50	50	Ø 2÷20 (Art. T119/ER32)	Z091.101.R ball bearing nut	RH
T118.830.R	60	63	50	Ø 2÷30 (Art. T123/ER40)	Z091.002.R	RH
T118.830.L	60	63	50	Ø 2÷30 (Art. T123/ER40)	Z091.002.L	LH
T118.832.R	60	63	50	Ø 2÷30 (Art. T123/ER40)	Z091.102.R ball bearing nut	RH

- Retaining pawl T118.891.R for:
Biesse (after 09/09/92), **Masterwood - Bulleri** (motor H.S.D.)

Item	A	D	D1	Spring collets	Clamping nut	Rot.
T118.804.R	68	50	50	Ø 2÷20 (Art. T119/ER32)	Z091.001.R	RH
T118.804.L	68	50	50	Ø 2÷20 (Art. T119/ER32)	Z091.001.L	LH
T118.806.R	68	50	50	Ø 2÷20 (Art. T119/ER32)	Z091.101.R ball bearing nut	RH
T118.834.R	68	63	50	Ø 2÷30 (Art. T123/ER40)	Z091.002.R	RH
T118.834.L	68	63	50	Ø 2÷30 (Art. T123/ER40)	Z091.002.L	LH
T118.836.R	68	63	50	Ø 2÷30 (Art. T123/ER40)	Z091.102.R ball bearing nut	RH

- Retaining pawl T118.792.R for:
Alberti, Vitap, Masterwood (motor G. Colombo)

Item	A	D	D1	Spring collets	Clamping nut	Rot.
T118.810.R	68	50	50	Ø 2÷20 (Art. T119/ER32)	Z091.001.R	RH
T118.810.L	68	50	50	Ø 2÷20 (Art. T119/ER32)	Z091.001.L	LH
T118.812.R	68	50	50	Ø 2÷20 (Art. T119/ER32)	Z091.101.R ball bearing nut	RH
T118.814.R	68	63	50	Ø 2÷30 (Art. T123/ER40)	Z091.002.R	RH
T118.814.L	68	63	50	Ø 2÷30 (Art. T123/ER40)	Z091.002.L	LH
T118.816.R	68	63	50	Ø 2÷30 (Art. T123/ER40)	Z091.102.R ball bearing nut	RH

- Retaining pawl T118.791.R (DIN 69872) for:
Busellato, Weeke, Ima, Bulleri, Maka, Cosmec, Reichenbacher

Item	A	D	D1	Spring collets	Clamping nut	Rot.
T118.820.R	68	50	50	Ø 2÷20 (Art. T119/ER32)	Z091.001.R	RH
T118.820.L	68	50	50	Ø 2÷20 (Art. T119/ER32)	Z091.001.L	LH
T118.822.R	68	50	50	Ø 2÷20 (Art. T119/ER32)	Z091.101.R ball bearing nut	RH
T118.824.R	68	63	50	Ø 2÷30 (Art. T123/ER40)	Z091.002.R	RH
T118.824.L	68	63	50	Ø 2÷30 (Art. T123/ER40)	Z091.002.L	LH
T118.826.R	68	63	50	Ø 2÷30 (Art. T123/ER40)	Z091.102.R ball bearing nut	RH

COLLET CHUCKS HSK TYPE "F"

ART. T118

- Supplied with nut (without collet)
- Threaded nut DIN 6499
- Threaded nut DIN 6388 (EOC25)

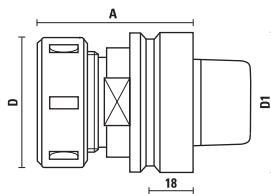

Item		A	D	D1	Spring collets	Clamping nut	Rot.
T118.966.R	HSK 50 F	73	50	50	Ø 2÷20 (Art. T119/ER32)	Z091.001.R	RH
T118.968.R	HSK 50 F	76	50	50	Ø 2÷20 (Art. T119/ER32)	Z091.101.R ball bearing nut	RH
T118.974.R	HSK 50 F	78	60	50	Ø 3÷26 (Art. T124/EOC25)	Z091.203.R	RH
T118.975.R	HSK 63 F	70	42	63	Ø 3÷16 (Art. T125/ER25)	Z091.103.R	RH
T118.976.R	HSK 63 F	75	50	63	Ø 2÷20 (Art. T119/ER32)	Z091.001.R	RH
T118.976.L	HSK 63 F	75	50	63	Ø 2÷20 (Art. T119/ER32)	Z091.001.L	LH
T118.978.R	HSK 63 F	76	50	63	Ø 2÷20 (Art. T119/ER32)	Z091.101.R ball bearing nut	RH
T118.980.R	HSK 63 F	75	63	63	Ø 2÷30 (Art. T123/ER40)	Z091.002.R	RH
T118.980.L	HSK 63 F	75	63	63	Ø 2÷30 (Art. T123/ER40)	Z091.002.L	LH
T118.982.R	HSK 63 F	78	63	63	Ø 2÷30 (Art. T123/ER40)	Z091.102.R ball bearing nut	RH
T118.983.R	HSK 63 F	78	60	63	Ø 3÷26 (Art. T124/EOC25)	Z091.202.R	RH
T118.984.R	HSK 63 F	78	60	63	Ø 3÷26 (Art. T124/EOC25)	Z091.203.R ball bearing nut	RH
T118.994.R	HSK 63 F	115	60	63	Ø 2÷30 (Art. T124/EOC25)	Z091.203.R ball bearing nut	RH

COLLET CHUCKS HSK63E

ART. T118

- Supplied with nut (without collet)
- Threaded nut DIN 6499

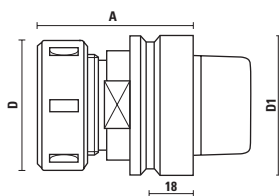

Item		A	D	D1	Spring collets	Clamping nut	Rot.
T118.985.R		76	50	63	Ø 2÷20 (Art. T119/ER32)	Z091.001.R	RH
T118.986.R		76	50	63	Ø 2÷30 (Art. T134/ETS32)	Z091.301.R	RH
T118.987.R		76	63	63	Ø 2÷30 (Art. T123/ER40)	Z091.002.R	RH
T118.988.R		76	63	63	Ø 4÷25 (Art. T135/ETS40)	Z091.302.R	RH

See the main catalogue KLEIN 14.A for more Tool Holders, or contact us:

Tel: 01748 897170

E-Mail: colin@cptooling.co.uk

ian@cptooling.co.uk

Website: www.cptooling.co.uk



COLLET CHUCKS HSK63F ER16 - G 2.5 BALANCING

ART. TK118

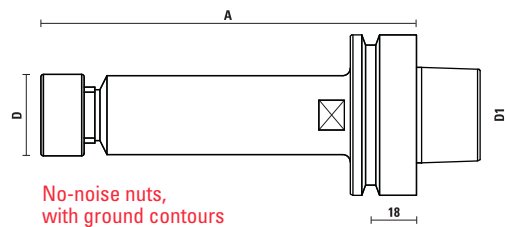

No-noise nuts,
with ground contours

- Balanced at grade G 2.5 at 36.000 RPM
- Noise and vibrations reduction
- Supplied with nut (without collet)
- Threaded nut DIN 6499

On request can be supplied the standard clamping nuts
(Items Z091 see page 7.26, 10.13)

Item	A	D	D1	Spring collets	Clamping nut	Rot.
TK118.900.R150	150	32	63	∅ 2÷10 (Art. T127/ER16)	Z091.505.R	Rh

COLLET CHUCKS HSK63F ER32 - G 2.5 BALANCING

ART. TK118

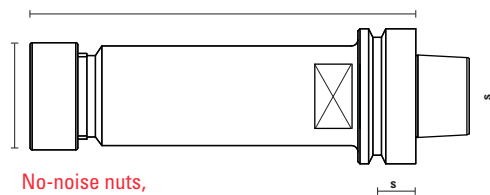

No-noise nuts,
with ground contours

- Balanced at grade G 2.5 at 36.000 RPM
- Noise and vibrations reduction
- Supplied with nut (without collet)
- Threaded nut DIN 6499

On request can be supplied the standard clamping nuts
(Items Z091 see page 7.26, 10.13)

Item	A	D	D1	Spring collets	Clamping nut	Rot.
TK118.976.R075	75	50	63	∅ 2÷20 (Art. T119/ER32)	Z091.501.R	Rh
TK118.976.R125	125	50	63	∅ 2÷20 (Art. T119/ER32)	Z091.501.R	Rh
TK118.976.R180	180	50	63	∅ 2÷20 (Art. T119/ER32)	Z091.501.R	Rh

COLLET CHUCKS HSK63F DIN6388/EOC25 - G 2.5 BALANCING

ART. TK118

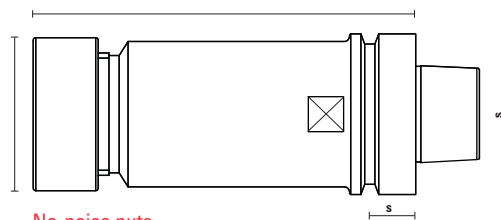

No-noise nuts,
with ground contours

- Balanced at grade G 2.5 at 36.000 RPM
- Noise and vibrations reduction
- Supplied with nut (without collet)
- Threaded nut DIN 6388 (EOC25)

On request can be supplied the standard clamping nuts
(Items Z091 see page 7.26, 10.13)

Item	A	D	D1	Spring collets	Clamping nut	Rot.
TK118.984.R078	78	60	63	∅ 3÷26 (Art. T124/ER25)	Z091.522.R	Rh
TK118.984.R115	115	60	63	∅ 3÷26 (Art. T124/ER25)	Z091.522.R	Rh
TK118.984.R150	150	60	63	∅ 3÷26 (Art. T124/ER25)	Z091.522.R	Rh
TK118.984.R200	200	60	63	∅ 3÷26 (Art. T124/ER25)	Z091.522.R	Rh

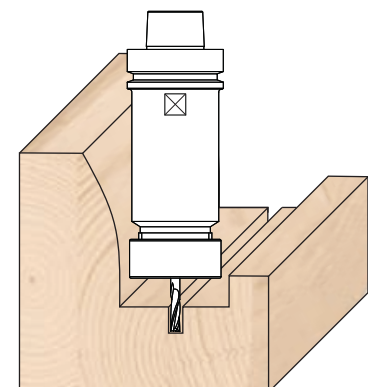
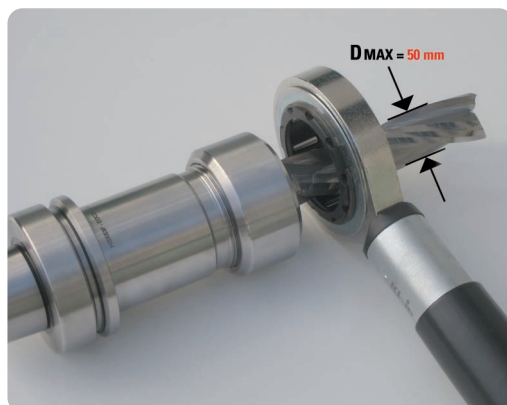

STAINLESS STEEL COLLET CHUCKS ISO 30 - INOX

ART. T118

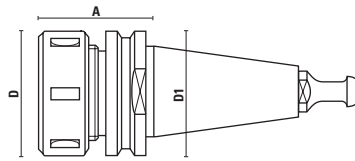

- Produced in stainless steel AISI 420
- Special micro-shot peening treatment;
- Supplied with nut (without collet) and retaining pawl;
- Needed when working with coolant: machines for marble, glass, aluminium working and others;
- Highly recommended when processing resinoid wood and composite materials
- Suggested when working in "humid" environment.
- Extremely low maintenance costs, easy to clean;
- When used with coolant our water-tight spring collets are suggested

Retaining paw T118.891.R For: **Biesse** (after 09/09/92), **Masterwood - Bulleri** (motor H.S.D.)

Item	A	D	D1	Spring collets	Clamping nut	Rot.
T118.800.RAI	50	50	50	Ø 2÷20 (Art. T119/ER32)	Z091.001.R	RH
T118.802.RAI	50	50	50	Ø 2÷20 (Art. T119/ER32)	Z091.101.R ball bearing nut	RH
T118.830.RAI	55	63	50	Ø 2÷30 (Art. T123/ER40)	Z091.002.R	RH
T118.832.RAI	55	63	50	Ø 2÷30 (Art. T123/ER40)	Z091.102.R ball bearing nut	RH

STAINLESS STEEL COLLET CHUCKS HSK63F - INOX

ART. T118

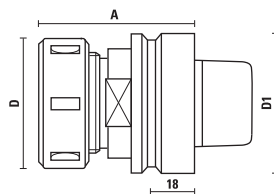

- Produced in stainless steel AISI 420
- Special micro-shot peening treatment;
- Supplied with nut (without collet) and retaining pawl;
- Needed when working with coolant: machines for marble, glass, aluminium working and others;
- Highly recommended when processing resinoid wood and composite materials
- Suggested when working in "humid" environment.
- Extremely low maintenance costs, easy to clean;
- When used with coolant our water-tight spring collets are suggested

Item	A	D	D1	Spring collets	Clamping nut	Rot.
T118.976.RAI	74	50	63	Ø 2÷20 (Art. T119/ER32)	Z091.001.R	RH
T118.978.RAI	74	50	63	Ø 2÷20 (Art. T119/ER32)	Z091.101.R ball bearing nut	RH
T118.980.RAI	77	63	63	Ø 2÷30 (Art. T123/ER40)	Z091.002.R	RH
T118.982.RAI	77	63	63	Ø 2÷30 (Art. T123/ER40)	Z091.102.R ball bearing nut	RH
T118.983.RAI	78	60	63	Ø 3÷26 (Art. T124/EOC25)	Z091.203.R	RH
T118.984.RAI	78	60	63	Ø 3÷26 (Art. T124/EOC25)	Z091.203.R ball bearing nut	RH

SPRING COLLETS ER 32 - DIN 6499

ART. T119

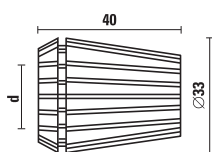

Precision= 0,01

Item	d
T119.020.N	Ø 2 - 1
T119.030.N	Ø 3 - 2
T119.032.N	Ø 3,2 - (1/8")
T119.040.N	Ø 4 - 3
T119.048.N	Ø 4,8 - (3/16")
T119.050.N	Ø 5 - 4
T119.060.N	Ø 6 - 5
T119.064.N	Ø 6,4 - (1/4")
T119.070.N	Ø 7 - 6
T119.079.N	Ø 7,9 - (5/16")
T119.080.N	Ø 8 - 7
T119.090.N	Ø 9 - 8
T119.095.N	Ø 9,5 - (3/8")
T119.100.N	Ø 10 - 9
T119.110.N	Ø 11 - 10
T119.120.N	Ø 12 - 11
T119.127.N	Ø 12,7 (1/2")
T119.130.N	Ø 13 - 12
T119.140.N	Ø 14 - 13
T119.150.N	Ø 15 - 14
T119.159.N	Ø 15,9 - (5/8")
T119.160.N	Ø 16 - 15
T119.170.N	Ø 17 - 16
T119.180.N	Ø 18 - 17
T119.190.N	Ø 19 - 18
T119.191.N	Ø 19,1 - (3/4")
T119.200.N	Ø 20 - 19

SPRING COLLET SET ER 32 - DIN 6499

ART. X119



- Complete with 18 pcs
- In carton Box

Item	Diameters:
X119.118.N	Ø3 - Ø4 - Ø5 - Ø6 - Ø7 - Ø8
	Ø9 - Ø10 - Ø11 - Ø12 - Ø13 - Ø14
	Ø15 - Ø16 - Ø17 - Ø18 - Ø19 - Ø20

SPRING COLLETS ER 40 - DIN 6499

ART. T123

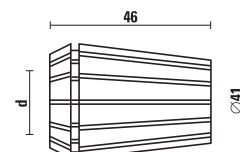

Precision= 0,01

Item	d
T123.030.N	Ø 3 - 2
T123.040.N	Ø 4 - 3
T123.048.N	Ø 4,8 - (3/16")
T123.050.N	Ø 5 - 4
T123.060.N	Ø 6 - 5
T123.064.N	Ø 6,4 - (1/4")
T123.070.N	Ø 7 - 6
T123.079.N	Ø 7,9 - (5/16")
T123.080.N	Ø 8 - 7
T123.090.N	Ø 9 - 8
T123.095.N	Ø 9,5 - (3/8")
T123.100.N	Ø 10 - 9
T123.110.N	Ø 11 - 10
T123.120.N	Ø 12 - 11
T123.127.N	Ø 12,7 - (1/2")
T123.130.N	Ø 13 - 12
T123.140.N	Ø 14 - 13
T123.150.N	Ø 15 - 14
T123.159.N	Ø 15,9 - (5/8")
T123.160.N	Ø 16 - 15
T123.170.N	Ø 17 - 16
T123.180.N	Ø 18 - 17
T123.190.N	Ø 19 - 18
T123.191.N	Ø 19,1 - (3/4")
T123.200.N	Ø 20 - 19
T123.210.N	Ø 21 - 20
T123.220.N	Ø 22 - 21
T123.230.N	Ø 23 - 22
T123.240.N	Ø 24 - 23
T123.250.N	Ø 25 - 24
T123.254.N	Ø 25,4 - (1")
T123.260.N	Ø 26 - 25
T123.300.N	Ø 30 - 29

SPRING COLLET SET ER 40 - DIN 6499

ART. X123



- Complete with 23 pcs
- In carton Box

Item	Diameters:
X123.023.N	Ø3 - Ø4 - Ø5 - Ø6 - Ø7 - Ø8
	Ø9 - Ø10 - Ø11 - Ø12 - Ø13 - Ø14
	Ø15 - Ø16 - Ø17 - Ø18 - Ø19 - Ø20
	Ø21 - Ø22 - Ø23 - Ø24 - Ø25

SPRING COLLETS EOC25 - DIN 6388 (462 E)

ART. T124

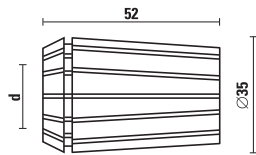

Precision= 0,01

Item	d
T124.020.N	Ø 2 - 1,5
T124.030.N	Ø 3 - 2,5
T124.040.N	Ø 4 - 3,5
T124.050.N	Ø 5 - 4,5
T124.060.N	Ø 6 - 5,5
T124.064.N	Ø 6,4 - (1/4")
T124.070.N	Ø 7 - 6,5
T124.080.N	Ø 8 - 7,5
T124.095.N	Ø 9,5 - (3/8")
T124.100.N	Ø 10 - 9,5
T124.110.N	Ø 11 - 10,5
T124.120.N	Ø 12 - 11,5
T124.127.N	Ø 12,7 - (1/2")
T124.130.N	Ø 13 - 12,5
T124.140.N	Ø 14 - 13,5
T124.159.N	Ø 15,9 - (5/8")
T124.160.N	Ø 16 - 15,5
T124.180.N	Ø 18 - 17,5
T124.191.N	Ø 19,1 - (3/4")
T124.200.N	Ø 20 - 19,5
T124.220.N	Ø 22 - 21,5
T124.250.N	Ø 25 - 24,5
T124.254.N	Ø 25,4 - (1")

SPRING COLLETS ER 20 - DIN 6499

ART. T126

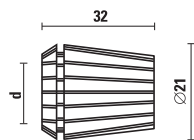

Precision= 0,01

Item	d
T126.030.N	Ø 3 - 2
T126.032.N	Ø 3,2 - (1/8")
T126.040.N	Ø 4 - 3
T126.050.N	Ø 5 - 4
T126.060.N	Ø 6 - 5
T126.064.N	Ø 6,4 - (1/4")
T126.080.N	Ø 8 - 7
T126.090.N	Ø 9 - 8
T126.095.N	Ø 9,5 - (3/8")
T126.100.N	Ø 10 - 9
T126.110.N	Ø 11 - 10
T126.120.N	Ø 12 - 11
T126.127.N	Ø 12,7 - (1/2")
T126.130.N	Ø 13 - 12

SPRING COLLETS ER 25 - DIN 6499

ART. T125

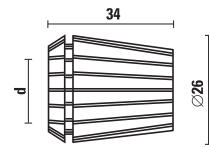

Precision= 0,01

Item	d
T125.030.N	Ø 3 - 2
T125.032.N	Ø 3,2 - (1/8")
T125.040.N	Ø 4 - 3
T125.048.N	Ø 4,8 - (3/16")
T125.050.N	Ø 5 - 4
T125.060.N	Ø 6 - 5
T125.064.N	Ø 6,4 - (1/4")
T125.070.N	Ø 7 - 6
T125.079.N	Ø 7,9 - (5/16")
T125.080.N	Ø 8 - 7
T125.090.N	Ø 9 - 8
T125.095.N	Ø 9,5 - (3/8")
T125.100.N	Ø 10 - 9
T125.110.N	Ø 11 - 10
T125.120.N	Ø 12 - 11
T125.127.N	Ø 12,7 - (1/2")
T125.130.N	Ø 13 - 12
T125.140.N	Ø 14 - 13
T125.150.N	Ø 15 - 14
T125.159.N	Ø 15,9 - (5/8")
T125.160.N	Ø 16 - 15

SPRING COLLET SET ER25 - DIN 6499

ART. X125



- Complete with 14 pcs
- In wooden Box

Item	Diameters:
X125.014.N	Ø3 - Ø4 - Ø5 - Ø6 - Ø7 - Ø8 - Ø9 Ø10 - Ø11 - Ø12 - Ø13 - Ø14 - Ø15 - Ø16

See the main catalogue KLEIN 14.A for more Spring Collets, or contact us:

Tel: 01748 897170
E-Mail: colin@cptooling.co.uk
ian@cptooling.co.uk
Website: www.cptooling.co.uk

SET IN WOODEN BOX

ART. X118



Complete with concentric chuck ISO30 + 8 spring collets ER32

Item	Item
X118.700.R	X118.800.R
complete with: concentric chuck ISO 30/ER32 T118.700.R	complete with: concentric chuck ISO 30/ER32 T118.800.R
spring collets Ø6 T119.060.N	spring collets Ø6 T119.060.N
Ø8 T119.080.N	Ø8 T119.080.N
Ø10 T119.100.N	Ø10 T119.100.N
Ø12 T119.120.N	Ø12 T119.120.N
Ø14 T119.140.N	Ø14 T119.140.N
Ø16 T119.160.N	Ø16 T119.160.N
Ø18 T119.180.N	Ø18 T119.180.N
Ø20 T119.200.N	Ø20 T119.200.N

SET IN PLASTIC BOX

ART. X118



- Complete with concentric chuck HSK63F + 8 spring collets ER40

Item	Item
X118.980.R	
complete with: concentric chuck HSK63F/ER40 T118.980.R	
spring collets Ø6 T123.060.N	
Ø8 T123.080.N	
Ø10 T123.100.N	
Ø12 T123.120.N	
Ø16 T123.160.N	
Ø18 T123.180.N	
Ø20 T123.200.N	
Ø25 T123.250.N	

SET IN PLASTIC BOX

ART. X118



- Complete with concentric chuck HSK63F + 8 spring collets ER32

Item	Item
X118.976.R	
complete with: concentric chuck HSK63F/ER32 T118.976.R	
spring collets Ø6 T119.060.N	
Ø8 T119.080.N	
Ø10 T119.100.N	
Ø12 T119.120.N	
Ø14 T119.140.N	
Ø16 T119.160.N	
Ø18 T119.180.N	
Ø20 T119.200.N	

SET IN PLASTIC BOX

ART. X118



- Complete with concentric chuck HSK63F with ball bearing nut + 8 spring collets EOC25

Item	Item
X118.984.R	
complete with: concentric chuck HSK63F/EOC25 T118.984.R	
spring collets Ø6 T124.060.N	
Ø8 T124.080.N	
Ø10 T124.100.N	
Ø12 T124.120.N	
Ø16 T124.160.N	
Ø18 T124.180.N	
Ø20 T124.200.N	
Ø25 T124.250.N	

CHIP & DUST CONVEYOR CLAMPING NUT

ART. T139

- Tool body in light alloy
- Surface hardening treatment
- Suitable for every type of collet chuck (HSK, ISO, BT, ...)
- Maximum tool diameter 70 mm
- Maximum speed rotation at 20.000 RPM
- Balanced at G2,5
- Weight 0,4 kg
- Single packed in carton box

Watch the Video on

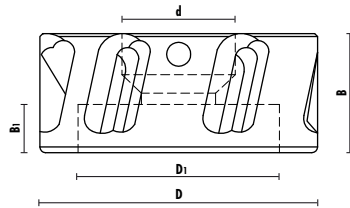

Item	Type	D	D ₁	B	B ₁	d	Rot.
T139.501.R	DIN6499 (ER32)	98	74	42	17	M 40x1,5	Dx/Rh
T139.502.R	DIN6499 (ER40)	98	74	42	17	M 50x1,5	Dx/Rh
T139.503.R	DIN6499 (ER25)	98	74	42	17	M 32x1,5	Dx/Rh
T139.522.R	DIN6388 (EOC25)	98	74	42	17	M 48x2	Dx/Rh
T139.581.R	DIN6499 (ER32)	80	64	42	13	M 40x1,5	Dx/Rh

CHIP & DUST CONVEYOR CLAMPING NUT SET

ART. X139



- Complete with:
n° 1 conveyor clamping nut
n° 1 wrench:
Ø 98= key 95/100
Ø 80= key 80/90
- Carton box

CHIP & DUST CONVEYOR CLAMPING NUT SET

ART. X139



- Complete with:
n° 2 conveyor clamping nuts
(ER32 - ER40)
n° 1 wrench 95/100
- Carton box

Item	Description	Type
X139.501.R	T139.501.R + Z052.315.N	DIN6499 (ER32)
X139.502.R	T139.502.R + Z052.315.N	DIN6499 (ER40)
X139.503.R	T139.503.R + Z052.315.N	DIN6499 (ER25)
X139.522.R	T139.522.R + Z052.315.N	DIN6388 (EOC25)
X139.581.R	T139.581.R + Z052.314.N	DIN6499 (ER32)

Item	Description
X139.990.R	T139.501.R + T139.502.R + Z052.315.N

Tornado: the new conveyor clamping nut helps both dust and chip evacuation during Nesting and conventional CNC Routing operations. Easy to assemble directly on the collet chuck instead of the standard nut, the new Klein Tornado provides a big improvement of dust evacuation, removing it from the workpiece directly into the centralized extraction system of the CNC machines.

EASY TO MOUNT LIKE A STANDARD CLAMPING NUT

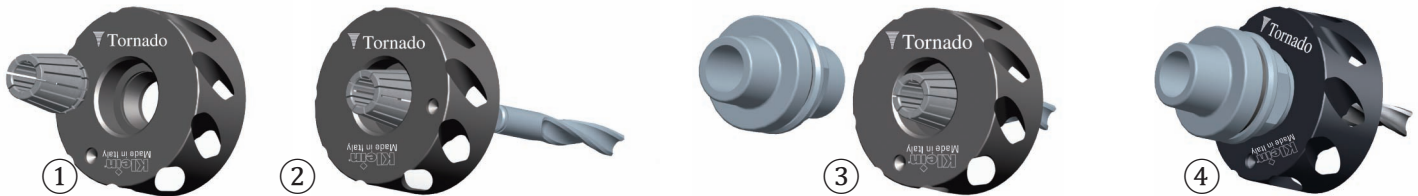

WORKING WITH TORNADO



WORKING WITHOUT TORNADO



TORQUE WRENCHES

While setting a tool it is extremely important to tighten it appropriately.

If not effectively tight indeed a cutting tool could slide away from the tool holder during the working process.

On the other side, an excessive tightening can cause damages to the tool holder or spring collet or the tool itself.

The wrench indicates when the torque (Nm) is reached according to the value in the corresponding table.

TORQUE WRENCHES FOR "MINI" NUTS

ART. Z052

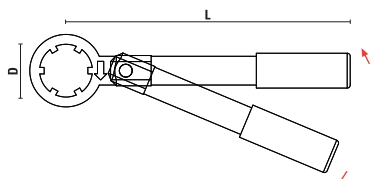

Item	D	L	Nm	Threaded nut
Z052.704.N	35	185	40	ER25

TORQUE WRENCHES FOR "STANDARD" NUTS

ART. Z052

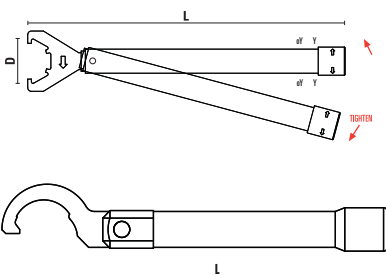

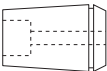
Dr. ①  Collets as per drawing n. 1 must be tightened by setting the minimum torque value and rotating the handle counterclockwise.

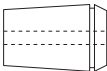
Dr. ②  Collets as per drawing n. 2 must be tightened by setting the maximum torque value and rotating the handle clockwise.

Item	D	L	Nm (Dr. 1)	Nm (Dr. 2)	Threaded nut
Z052.712.N	40	400	40-55	80-90	ER25
Z052.713.N	50	400	66-70	120-130	ER32
Z052.714.N	63	450	110-120	190-200	ER40
Z052.732.N	58-62	380	110-120	190-200	DIN6388

TORQUE WRENCHES FOR "NO-NOISE" NUTS

ART. Z052

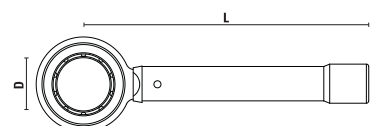

Item	D	L	Nm (dis. 1)	Nm (dis. 2)	Threaded nut
Z052.790.N	32	400	25-35	45-55	ER 16
Z052.793.N	50	400	65-70	120-130	ER 32
Z052.795.N	60	400	110-120	190-200	DIN 6388/EOC25

KEYS

ART. Z052

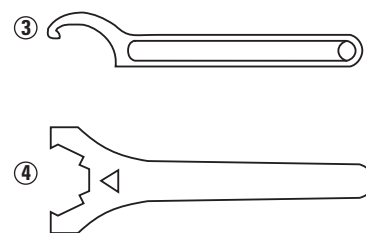

Item	Draw.	Description	Threaded nut
Z052.300.N	3	Wrench 34/38	DIN6388/EOC12
Z052.301.N	3	Wrench 40/42	Z091.000.R
Z052.310.N	3	Wrench 58/62	DIN6388/EOC25

Z052.401.N	4	Wrench for collet nut ER 32 "standard" type
Z052.402.N	4	Wrench for collet nut ER 40 "standard" type
Z052.407.N	4	Wrench for collet nut ER 25 "standard" type

COLLET NUTS

ART. Z091

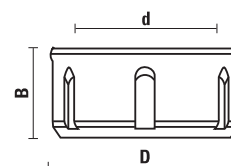

Item	Type	D	B	d	Rot.
Z091.000.R	For spring collet T117	40	20	M 30x1,5	RH
Z091.000.L	For spring collet T117	40	20	M 30x1,5	LH
Z091.001.R	DIN 6499 (ER 32)	50	23	M 40x1,5	RH
Z091.001.L	DIN 6499 (ER 32)	50	23	M 40x1,5	LH
Z091.002.R	DIN 6499 (ER 40)	63	25	M 50x1,5	RH
Z091.002.L	DIN 6499 (ER 40)	63	25	M 50x1,5	LH
Z091.100.R	DIN 6499 (ER 25) ball bearing	42	20	M 32x1,5	RH
Z091.101.R	DIN 6499 (ER 32) ball bearing	50	26	M 40x1,5	RH
Z091.102.R	DIN 6499 (ER 40) ball bearing	63	29	M 50x1,5	RH
Z091.103.R	DIN 6499 (ER 25)	42	20	M 32x1,5	RH
Z091.104.R	DIN 6499 (ER 20)	35	19	M 25x1,5	RH
Z091.105.R	DIN 6499 (ER 16)	32	17,5	M 22x1,5	RH
Z091.202.R	DIN 6388 (EOC25)	60	30	M 48x2	RH
Z091.203.R	DIN 6388 (EOC25) ball bearing	60	30	M 48x2	RH
Z091.205.R	DIN 6388 (EOC12)	35	28	M 27x1,5	RH
Z091.301.R	ETS 32	50	23	M 40x1,5	RH
Z091.302.R	ETS 40	63	25	M 50x1,5	RH

"NO-NOISE" COLLET NUTS

ART. Z091

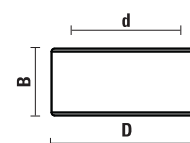

- Recommended when using router bits working at higher RPM
- Threaded nut with ground contours, remarkable reduction of noise

Item	Type	D	B	d	Rot.
Z091.501.R	DIN 6499 (ER 32)	50	23	M 40x1,5	RH
Z091.505.R	DIN 6499 (ER 16)	32	17,5	M 22x1,5	RH
Z091.522.R	DIN 6499 (EOC 25)	60	30	M 48x2	RH

All spare parts in the section n. 10 of the main catalogue

ADAPTERS FOR CIRCULAR SAWBLADES

ART. T128

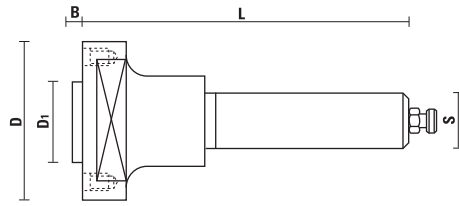

- Nr. 4 pin holes with M6/90° and 48 mm pitch circle diameter
- Complete with nr. 4 screws to fix the sawblade
- For mounting of sawblades with 30 mm bore
- Recommended to use sawblades with diameters between 150 and 200 mm

Item	D	D1	B	S	L
T128.140.R	60	30	2,5	Ø20x60	90



Z051.014.R



Z051.506.R

HSK63F ADAPTERS FOR CIRCULAR SAWBLADES

ART. T128

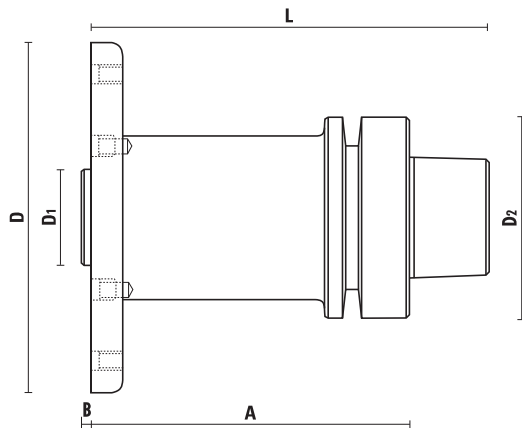

- For mounting Saws with 30 mm bore
- 6 screws M6/60° at 90 mm distance
- For mounting Saw Blades with diameter between 200 and 350 mm.

Item	A	D	D1	D2	B	L
T128.160.R	40	110	30	63	3	65
T128.165.R	100	110	30	63	3	125



Z051.014.R

EXAMPLE OF USE:
HSK63F adapter with mounted Saw Blade

TECHNICAL DATA OF SAW BLADE PIN HOLES:
6 Pin holes with 6 mm. diameter at 60° degrees and 90mm. pitch circle diameter

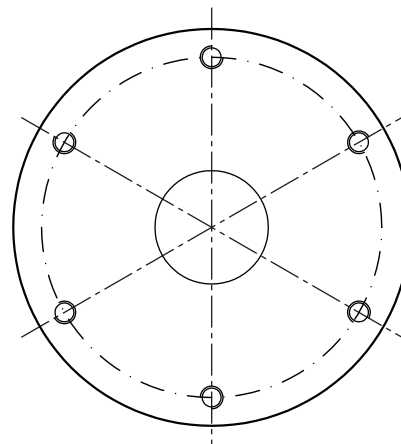
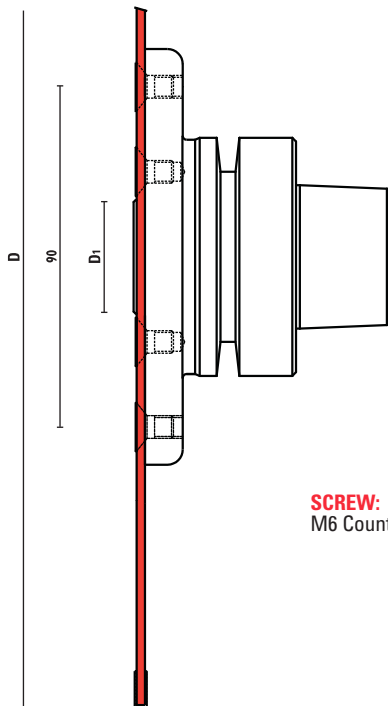

SCREW:
M6 Countersunk flat head screw

CUTTER ARBORS WITH HSK63F TAPER

ART. T128

- Complete with end cap

- Nr. 3 pin holes to 120°

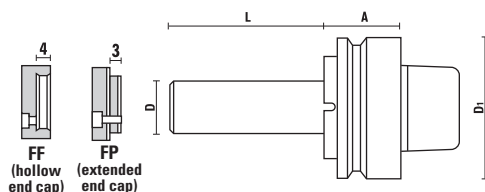

Item		A	D	D1	L	End cap
T128.970.R	HSK 63 F	33	30	63	70	FF - Z092.001.R
T128.970.RM	HSK 63 F	33	30	63	70	FP - Z092.002.R
T128.980.R	HSK 63 F	33	30	63	100	FF - Z092.001.R
T128.980.RM	HSK 63 F	33	30	63	100	FP - Z092.002.R
T128.980.R060M	HSK 63 F	33	30	63	60	FP - Z092.002.R
T128.980.R075M	HSK 63 F	33	30	63	75	FP - Z092.002.R
T128.980.R080M	HSK 63 F	33	30	63	80	FP - Z092.002.R
T128.980.R090M	HSK 63 F	33	30	63	90	FP - Z092.002.R
T128.980.R095M	HSK 63 F	33	30	63	95	FP - Z092.002.R
T128.980.R105M	HSK 63 F	33	30	63	105	FP - Z092.002.R
T128.980.R110M	HSK 63 F	33	30	63	110	FP - Z092.002.R
T128.980.R115M	HSK 63 F	33	30	63	115	FP - Z092.002.R
T128.980.R120M	HSK 63 F	33	30	63	120	FP - Z092.002.R
T128.980.R125M	HSK 63 F	33	30	63	125	FP - Z092.002.R
T128.980.R130M	HSK 63 F	33	30	63	130	FP - Z092.002.R
T128.980.R135M	HSK 63 F	33	30	63	135	FP - Z092.002.R
T128.980.R140M	HSK 63 F	33	30	63	140	FP - Z092.002.R
T128.980.R145M	HSK 63 F	33	30	63	145	FP - Z092.002.R
T128.980.R150M	HSK 63 F	33	30	63	150	FP - Z092.002.R
T128.980.R180M	HSK 63 F	33	30	63	180	FP - Z092.002.R
T128.980.1x125M	HSK 63 F	33	1"	63	125	FP - Z092.008.R
T128.980.1,25x125M	HSK 63 F	33	1-1/4"	63	125	FP - Z092.010.R
T128.980.35x100	HSK 63 F	33	35	63	100	FF - Z092.003.R
T128.980.35x100M	HSK 63 F	33	35	63	100	FP - Z092.004.R
T128.980.40x100	HSK 63 F	33	40	63	100	FF - Z092.005.R
T128.980.40x100M	HSK 63 F	33	40	63	100	FP - Z092.006.R

Item		A	D	D1	L	End cap
T128.972.R	HSK 63 F	42	30	63	70	FF - Z092.001.R
T128.972.RM	HSK 63 F	42	30	63	70	FP - Z092.002.R
T128.982.R	HSK 63 F	42	30	63	100	FF - Z092.001.R
T128.982.RM	HSK 63 F	42	30	63	100	FP - Z092.002.R
T128.982.R080	HSK 63 F	42	30	63	80	FF - Z092.001.R
T128.982.R080M	HSK 63 F	42	30	63	80	FP - Z092.002.R
T128.982.R125	HSK 63 F	42	30	63	125	FF - Z092.001.R
T128.982.R125M	HSK 63 F	42	30	63	125	FP - Z092.002.R
T128.982.1,25x125M	HSK 63 F	42	1-1/4"	63	125	FP - Z092.010.R
T128.982.35x100	HSK 63 F	42	35	63	100	FF - Z092.003.R
T128.982.35x100M	HSK 63 F	42	35	63	100	FP - Z092.004.R

CUTTER ARBORS WITH HSK63E

T128.988.R	HSK 63 E	42	30	63	100	FF - Z092.001.R
------------	----------	----	----	----	-----	-----------------



Z051.016.R

CUTTER ARBORS WITH HSK85 TAPER

ART. T130 - T131 - T132

- Complete with end cap
- Nr. 3 pin holes to 120°

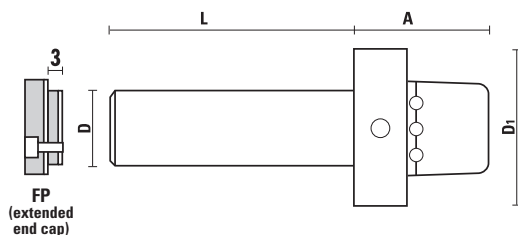

for: **Weinig Powerlock system**

Item	A	D	D1	L	End cap
T130.060.N	58	30	85	60	FP - Z092.002.R
T130.080.N	58	30	85	80	FP - Z092.002.R
T130.100.N	58	30	85	100	FP - Z092.002.R
T130.130.N	58	30	85	130	FP - Z092.002.R
T130.150.N	58	30	85	150	FP - Z092.002.R
T130.180.N	58	30	85	180	FP - Z092.002.R
T130.200.N	58	30	85	200	FP - Z092.002.R
T130.230.N	58	30	85	230	FP - Z092.002.R
T130.240.N	58	30	85	240	FP - Z092.002.R
T131.080.N	58	35	85	80	FP - Z092.004.R
T131.100.N	58	35	85	100	FP - Z092.004.R
T131.120.N	58	35	85	120	FP - Z092.004.R
T131.150.N	58	35	85	150	FP - Z092.004.R
T131.200.N	58	35	85	200	FP - Z092.004.R
T132.060.N	58	40	85	60	FP - Z092.006.R
T132.080.N	58	40	85	80	FP - Z092.006.R
T132.100.N	58	40	85	100	FP - Z092.006.R
T132.150.N	58	40	85	150	FP - Z092.006.R
T132.180.N	58	40	85	180	FP - Z092.006.R
T132.200.N	58	40	85	200	FP - Z092.006.R
T132.240.N	58	40	85	240	FP - Z092.006.R



Z051.016.R

CUTTER ARBORS WITH HSK85S TAPER

ART. T132

- Complete with end cap
- Nr. 3 pin holes to 120°

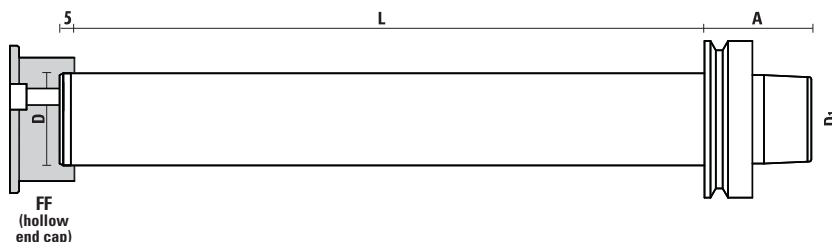

for: **SCM**

Item	A	D	D1	L	End cap
T132.320.NS	58	50	85	320	FF - Z092.050.R



Z051.016.R

SPACERS 2-SIDES GRINDED

ART. YD300 - YD350 - YD400

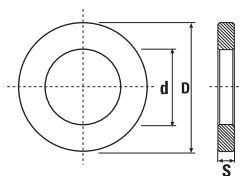

- For arbors Art. T128 - Art. T130 - Art. T131 - Art. T132
- Burnished
- Spacer rings fine-blanking processed for thickness $0,1 \pm 1$ mm (tolerance $\pm 0,02$)
- Spacer rings grinded on two sides for thickness 2-50 mm (tolerance $\pm 0,01$)

Item	D	D1	S
YD300.001	30	50	0,1
YD300.002	30	50	0,2
YD300.005	30	50	0,5
YD300.010	30	50	1
YD300.020	30	50	2
YD300.030	30	50	3
YD300.040	30	50	4
YD300.050	30	50	5
YD300.060	30	50	6
YD300.080	30	50	8
YD300.100	30	50	10
YD300.120	30	50	12
YD300.150	30	50	15
YD300.200	30	50	20
YD300.250	30	50	25
YD300.300	30	50	30
YD300.400	30	50	40
YD300.500	30	50	50
YD350.001	35	55	0,1
YD350.002	35	55	0,2
YD350.005	35	55	0,5
YD350.010	35	55	1
YD350.020	35	55	2
YD350.030	35	55	3
YD350.040	35	55	4
YD350.050	35	55	5
YD350.060	35	55	6
YD350.080	35	55	8
YD350.100	35	55	10
YD350.120	35	55	12
YD350.150	35	55	15
YD350.200	35	55	20
YD350.250	35	55	25
YD350.300	35	55	30
YD350.400	35	55	40
YD350.500	35	55	50

Item	D	D1	S
YD400.001	40	60	0,1
YD400.002	40	60	0,2
YD400.005	40	60	0,5
YD400.010	40	60	1
YD400.020	40	60	2
YD400.030	40	60	3
YD400.040	40	60	4
YD400.050	40	60	5
YD400.060	40	60	6
YD400.080	40	60	8
YD400.100	40	60	10
YD400.120	40	60	12
YD400.150	40	60	15
YD400.200	40	60	20
YD400.250	40	60	25
YD400.300	40	60	30
YD400.400	40	60	40
YD400.500	40	60	50
YD500.001	50	70	0,1
YD500.002	50	70	0,2
YD500.005	50	70	0,5
YD500.010	50	70	1
YD500.020	50	70	2
YD500.030	50	70	3
YD500.040	50	70	4
YD500.050	50	70	5
YD500.060	50	70	6
YD500.080	50	70	8
YD500.100	50	70	10
YD500.120	50	70	12
YD500.150	50	70	15
YD500.200	50	70	20
YD500.250	50	70	25
YD500.300	50	70	30
YD500.400	50	70	40
YD500.500	50	70	50
YD600.001	60	80	0,1
YD600.002	60	80	0,2
YD600.005	60	80	0,5
YD600.010	60	80	1
YD600.020	60	80	2
YD600.030	60	80	3
YD600.040	60	80	4
YD600.050	60	80	5
YD600.060	60	80	6
YD600.080	60	80	8
YD600.100	60	80	10
YD600.120	60	80	12
YD600.150	60	80	15
YD600.200	60	80	20
YD600.250	60	80	25
YD600.300	60	80	30
YD600.400	60	80	40
YD600.500	60	80	50



SPACERS SET

ART. YD300 - YD350 - YD400 - YD500 - YD600

Item	D	D1
YD300.990	30	50
YD350.990	35	55
YD400.990	40	60
YD500.990	50	70
YD600.990	60	80

Complete with:

nr. 4 sp. 2 mm - nr. 3 sp. 4 mm - nr. 2 sp. 5 mm
nr. 2 sp. 10 mm - nr. 1 sp. 20 mm - nr. 1 sp. 30 mm

ADJUSTABLE DEMOUNT DEVICES

ART. T139

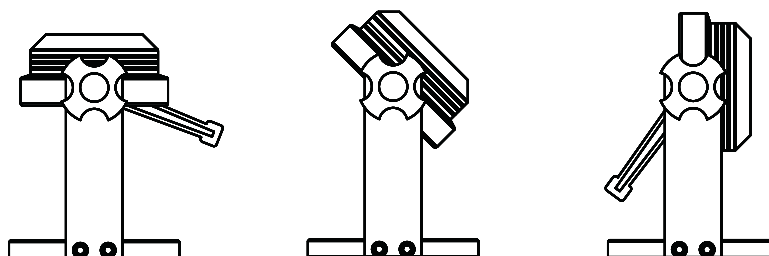

- Tool holder to be blocked on the flange diameter
- It is adjustable from 0° to 90°

Item	Machine
T139.150.N	For ISO 30 tool holder Ø 50 mm
T139.158.N	For ISO 30 tool holder Ø 58 (Motor ELTE/ESSETEAM)
T139.163.N	For HSK63 tool holder Ø 63
T139.164.N	For ISO 40 tool holder Ø 63,5

DEMOUNT DEVICES FOR FLANGE Ø80 - Ø85

ART. T139

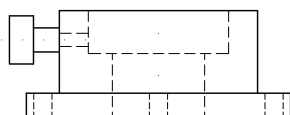

Tool holder to be blocked on the flange diameter

Item	Machine
T139.180.N	For tool holder Ø 80 mm
T139.185.N	For tool holder Ø 85 mm (Weinig, SCM)

WIPE OFF KIT

ART. X137

- For boring machines and CNC router machines
- Carton box

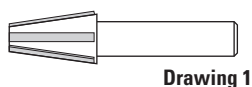

Drawing 1

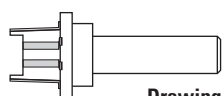

Drawing 2

Item	Concentric chuck	Drawing
T137.002.N	Taper 2 (MK2)	1
T137.003.N	Taper 3 (MK3)	1

T137.030.N	ISO 30/BT 30	1
T137.040.N	ISO 40/BT 40	1

T137.163.N	HSK 63 A-C-E	2
------------	--------------	---

T137.263.N	HSK 63 B-D-F	2
------------	--------------	---

Item	Collet type
T137.525.N	ER 25-ETS 25-DIN6499
T137.532.N	ER 32-ETS 32-DIN6499
T137.540.N	ER 40-ETS 40-DIN6499

T137.662.N	EOC 25-DIN 6388
------------	-----------------

Item	Description
X137.000.N	HSK63F/ER32 T137.263.N + T137.532.N + X137.004.N
X137.001.N	ISO30/ER32 T137.030.N + T137.532.N + X137.004.N
X137.002.N	HSK63F/DIN6388 T137.263.N + T137.662.N + X137.004.N
X137.005.N	HSK63F/ER40 T137.263.N + T137.540.N + X137.004.N
X137.006.N	ISO30/ER40 T137.030.N + T137.540.N + X137.004.N

Item	Collet bore
T137.906.N	3÷6
T137.911.N	6,4÷11
T137.918.N	12÷18
T137.925.N	19÷25

X137.004.N	Collet brush set 3÷25
------------	-----------------------

SOLID CARBIDE SPIRAL CUTTERS, FINISH STYLE Z=1

ART. T141

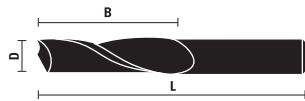

- Right-hand rotation with "UP CUT SPIRAL"
 - To be used on machining centres, CNC routers and point to point machines

RH rotation	D	B	L	Z
T141.030.R	3	12	50	1
T141.040.R	4	12	50	1
T141.050.R	5	17	50	1
T141.060.R	6	17	60	1
T141.061.R	6	27	60	1
T141.064.R	6,4	28	60	1
T141.080.R	8	22	80	1
T141.081.R	8	32	80	1
T141.100.R	10	32	80	1
T141.101.R	10	42	100	1
T141.120.R	12	32	80	1
T141.121.R	12	42	100	1

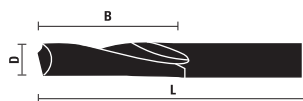

- Left-hand rotation with "DOWN CUT SPIRAL"
 - To be used on machining centres, CNC routers and point to point machines

LH rotation	D	B	L	Z
T141.061.L	6	27	60	1
T141.080.L	8	22	80	1
T141.081.L	8	32	80	1
T141.100.L	10	32	100	1

SOLID CARBIDE SPIRAL CUTTERS, FINISH STYLE Z=2

ART. T142

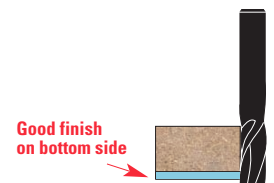
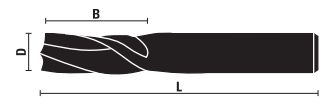

- Right-hand rotation with "UP CUT SPIRAL"
 - To be used on machining centres, CNC routers and point to point machines

RH rotation	D	B	L	Z
T142.030.R	3	12	50	2
T142.040.R	4	12	50	2
T142.050.R	5	17	50	2
T142.060.R	6	17	60	2
T142.061.R	6	27	60	2
T142.080.R	8	22	80	2
T142.081.R	8	35	80	2
T142.100.R	10	35	80	2
T142.101.R	10	45	100	2
T142.110.R	11	35	80	2
T142.111.R	11	45	100	2
T142.120.R	12	35	80	2
T142.121.R	12	45	100	2
T142.122.R	12	55	100	2
T142.140.R	14	45	100	2
T142.141.R	14	55	100	2
T142.142.R	14	80	140	2
T142.160.R	16	45	100	2
T142.161.R	16	55	100	2
T142.162.R	16	72	120	2
T142.180.R	18	55	100	2
T142.181.R	18	72	120	2
T142.182.R	18	102	150	2
T142.200.R	20	55	100	2
T142.201.R	20	72	120	2
T142.202.R	20	102	150	2

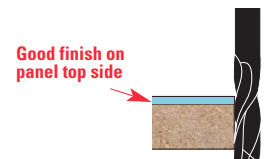
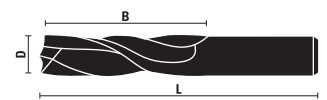

- Left-hand rotation with "DOWN CUT SPIRAL"
 - To be used on machining centres, CNC routers and point to point machines

LH rotation	D	B	L	Z
T142.030.L	3	12	50	2
T142.040.L	4	12	50	2
T142.060.L	6	17	60	2
T142.081.L	8	35	80	2
T142.100.L	10	35	80	2
T142.120.L	12	35	90	2
T142.140.L	14	45	100	2
T142.160.L	16	45	100	2
T142.161.L	16	55	100	2
T142.180.L	18	55	115	2
T142.182.L	18	102	165	2
T142.200.L	20	55	120	2

Router bits with diameter from 12 mm, are produced with shank for Seeger retaining rings



SOLID CARBIDE SPIRAL CUTTERS, FINISH STYLE Z=3

ART. T143

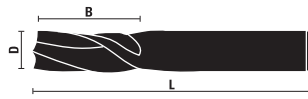

Good finish on bottom side



- Right-hand rotation with "UP CUT SPIRAL"
- To be used on machining centres, CNC routers and point to point machines

RH rotation	D	B	L	Z
T143.080.R	8	22	80	3
T143.081.R	8	35	80	3
T143.100.R	10	35	80	3
T143.101.R	10	45	100	3
T143.120.R	12	35	80	3
T143.121.R	12	45	100	3
T143.122.R	12	55	100	3
T143.140.R	14	45	100	3
T143.141.R	14	55	100	3
T143.160.R	16	45	100	3
T143.161.R	16	55	100	3
T143.162.R	16	72	120	3
T143.180.R	18	55	100	3
T143.181.R	18	72	120	3
T143.182.R	18	102	150	3
T143.200.R	20	55	100	3
T143.201.R	20	72	120	3
T143.202.R	20	102	150	3
T143.250.R	25	102	150	3

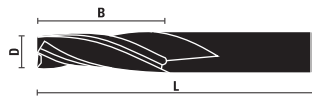

Good finish on panel top side

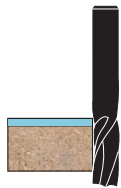

- Left-hand rotation with "DOWN CUT SPIRAL"
- To be used on machining centres, CNC routers and point to point machines

LH rotation	D	B	L	Z
T143.081.L	8	35	80	3
T143.101.L	10	45	100	3
T143.120.L	12	35	85	3
T143.160.L	16	45	100	3
T143.180.L	18	55	115	3
T143.200.L	20	55	115	3
T143.201.L	20	72	130	3

Router bits with diameter from 12 mm to 20 mm, are produced with shank for Seeger retaining rings



SOLID CARBIDE SPIRAL CUTTERS, ROUGHING STYLE Z=3

ART. T144

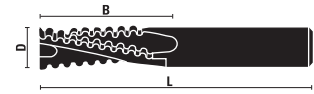

- Right-hand rotation with "UP-CUT STYLE"
- Chip-breaker execution
- To be used on machining centres, CNC routers and point to point machines
- Suitable for roughing, they guarantee a high feed rate

RH rotation	D	B	L	Z
T144.080.R	8	22	80	3
T144.081.R	8	35	80	3
T144.100.R	10	35	80	3
T144.101.R	10	45	100	3
T144.120.R	12	35	80	3
T144.121.R	12	45	100	3
T144.122.R	12	55	100	3
T144.123.R	12	42	90	3
T144.140.R	14	45	100	3
T144.141.R	14	55	100	3
T144.142.R	14	58	110	3
T144.160.R	16	45	100	3
T144.161.R	16	55	100	3
T144.162.R	16	72	120	3
T144.163.R	16	62	110	3
T144.180.R	18	55	100	3
T144.181.R	18	72	120	3
T144.182.R	18	102	150	3
T144.200.R	20	55	100	3
T144.201.R	20	72	120	3
T144.202.R	20	102	150	3
T144.250.R	25	102	150	3

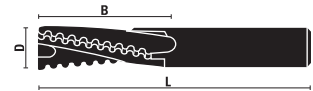

- Left-hand rotation with "DOWN-CUT STYLE"
- Chip-breaker execution
- To be used on machining centres, CNC routers and point to point machines
- Suitable for roughing, they guarantee a high feed rate

LH rotation	D	B	L	Z
T144.081.L	8	35	80	3
T144.100.L	10	35	80	3
T144.121.L	12	45	100	3
T144.122.L	12	55	105	3
T144.141.L	14	55	110	3
T144.160.L	16	45	100	3
T144.161.L	16	55	110	3
T144.162.L	16	72	125	3
T144.180.L	18	55	115	3
T144.200.L	20	55	115	3

SOLID CARBIDE COMPRESSION CUTTERS Z=1+1

ART. T155

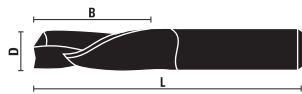

Excellent finish on both upper and lower side

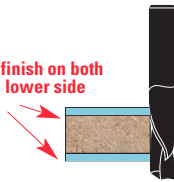

- Right-hand rotation with double flute, compression spiral
- To be used on machining centres, CNC routers and point to point machines

RH rotation	D	B	L	Z
T155.061.R	6	27	60	1+1
T155.080.R	8	22	80	1+1
T155.081.R	8	32	80	1+1
T155.100.R	10	32	80	1+1
T155.101.R	10	42	100	1+1
T155.120.R	12	42	100	1+1
T155.121.R	12	52	100	1+1
T155.127.R	12,7	32	78	1+1
T155.161.R	16	52	100	1+1

SOLID CARBIDE COMPRESSION CUTTERS Z=2+2

ART. T156



Excellent finish on both upper and lower side

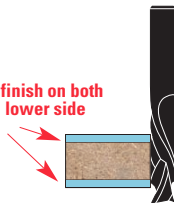

- Right-hand rotation with double flute, compression spiral
- To be used on machining centres, CNC routers and point to point machines

RH rotation	D	B	L	Z
T156.080.R	8	22	80	2+2
T156.081.R	8	32	80	2+2
T156.100.R	10	32	80	2+2
T156.101.R	10	42	100	2+2
T156.120.R	12	42	100	2+2
T156.121.R	12	52	110	2+2
T156.127.R	12,7	32	78	2+2
T156.140.R	14	42	100	2+2
T156.141.R	14	52	110	2+2
T156.160.R	16	42	100	2+2
T156.161.R	16	52	110	2+2
T156.162.R	16	72	130	2+2
T156.180.R	18	52	115	2+2
T156.181.R	18	72	135	2+2
T156.182.R	18	102	165	2+2
T156.200.R	20	52	115	2+2
T156.201.R	20	72	135	2+2

Router bits with diameter from 25 mm, are produced with shank for Seeger retaining rings



SOLID CARBIDE COMPRESSION CUTTERS Z=3+3

ART. T356

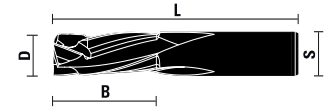

Excellent finish on both upper and lower side

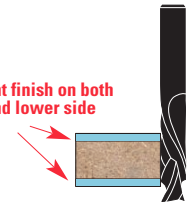

- Right-hand rotation with double flute, compression spiral
- To be used on machining centres, CNC routers and point to point machines

RH rotation	D	B	L	Z
T356.080.R	8	22	70	3+3
T356.100.R	10	22	70	3+3
T356.101.R	10	32	70	3+3
T356.120.R	12	32	80	3+3
T356.121.R	12	42	100	3+3
T356.160.R	16	42	100	3+3
T356.161.R	16	52	100	3+3



Excellent finish on both upper and lower side

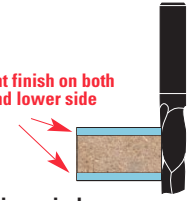

- Right-hand rotation with double flute, compression spiral
- To be used on machining centres, CNC routers and point to point machines

LH rotation	D	B	L	Z
T155.061.L	6	27	60	1+1
T155.081.L	8	32	80	1+1
T155.100.L	10	32	80	1+1
T155.120.L	12	42	100	1+1

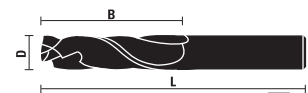

Excellent finish on both upper and lower side

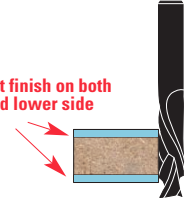

- Left-hand rotation with double flute, compression spiral
- To be used on machining centres, CNC routers and point to point machines

RH rotation	D	B	L	Z
T156.080.L	8	22	80	2+2
T156.081.L	8	32	80	2+2
T156.101.L	10	42	100	2+2
T156.120.L	12	42	100	2+2
T156.121.L	12	52	105	2+2
T156.161.L	16	52	110	2+2
T156.180.L	18	52	115	2+2
T156.200.L	20	52	115	2+2
T156.201.L	20	72	135	2+2

SOLID CARBIDE SPIRAL CUTTERS Z=2 - Z=3

ART. T157

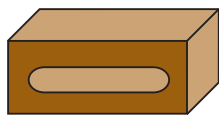
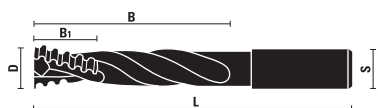

- Right-hand rotation with "UP CUT SPIRAL"
- Chip-breaker execution
- For locks and slot mortising

RH rotation	D	B ₁	B	L	S	Z
T157.140.R	14	20	95	155	14x45	2
T157.141.R	14	45	95	150	14x45	3
T157.160.R	16	25	115	175	16x45	2
T157.161.R	16	45	95	140	16x45	2
T157.162.R	16	50	100	150	16x45	3
T157.180.R	18	25	115	175	18x45	2
T157.181.R	18	50	100	150	18x45	3

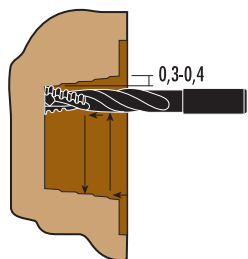

USE EXAMPLE

- Z=2/Z=3
- D= 14÷18 mm: RPM 12.000-20.000
- Stepwise processing 0,3-0,4 mm
- Can work deeply and have excellent chip evacuation

SOLID CARBIDE SPIRAL CUTTERS Z=3 FOR LOCKS

ART. T177 - T178

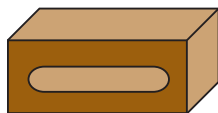

- Without chip-breaker
- For locks and slot mortising
- T177.160.R right rotation and right hand twist (positive/up cut style)
- T177.160.L left rotation and left hand twist (positive/up cut style)
- T178.160.R right rotation and left hand twist (negative/down cut style)

RH rotation	LH rotation	D	B ₁	B	L	S	Z
T177.160.R	T177.160.L	16	50	100	150	16x45	3
T178.160.R		16	50	100	150	16x45	3

Router bits with diameter from 25 mm, are produced with shank for Seeger retaining rings



SOLID CARBIDE SPIRAL CUTTERS Z=2

ART. T158

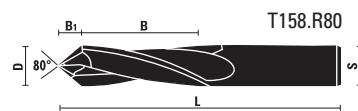
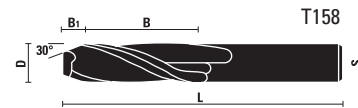

- Right-hand rotation with "UP CUT SPIRAL"
- For spy holes
- For boring and routing

RH rotation	D	B ₁	B	L	S	Z
T158.140.R	14	8	42	100	14	2
T158.160.R	16	9	52	120	16	2
T158.180.R	18	10	52	120	18	2
T158.200.R	20	11	52	120	20	2
T158.080.R80	8	4,8	38	80	8	2
T158.100.R80	10	6	46	100	10	2
T158.120.R80	12	7,2	50	110	12	2
T158.160.R80	16	9,6	52	120	16	2

SOLID CARBIDE SPIRAL CUTTERS Z=2

ART. T159

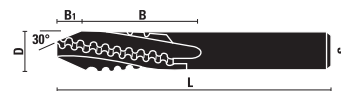

- Right-hand rotation with "UP CUT SPIRAL"
- Chip-breaker execution
- For spyholes on doors
- Through holes cutting

RH rotation	D	B ₁	B	L	S	Z
T159.160.R	16	9	52	120	16	2
T159.200.R	20	11	52	120	20	2

SOLID CARBIDE SPIRAL CUTTERS Z=3

ART. T146 - T147

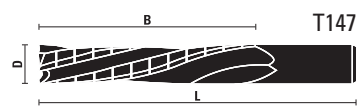
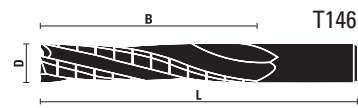

- Right-hand rotation with "UP CUT SPIRAL" (art. T146)
- Left-hand rotation with "UP CUT SPIRAL" (art. T147)
- Discontinuous cutting edge
- To be used on machining centres, CNC routers and point to point machines

RH rotation	D	B	L	Z
T146.250.R	25	140	200	3
LH rotation	D	B	L	Z
T147.250.L	25	140	200	3

SOLID CARBIDE SPIRAL CUTTERS, FINISH STYLE S=6 Z=2

ART. T160

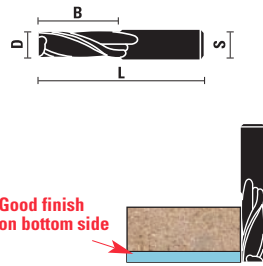

- Can also be used on portable routers
- Right-hand rotation with "UP CUT SPIRAL"

RH rotation	D	B	L	S	Z
T160.030.R	3	12	60	6	2
T160.035.R	3,5	14	60	6	2
T160.040.R	4	14	60	6	2
T160.045.R	4,5	16	60	6	2
T160.050.R	5	17	60	6	2

SOLID CARBIDE SPIRAL CUTTERS, FINISH STYLE S=6 Z=2

ART. T161

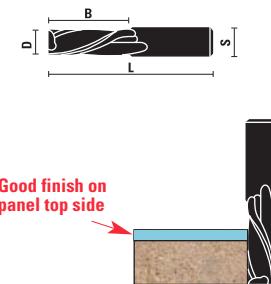

- Can also be used on portable routers
- Right-hand rotation with "DOWN CUT SPIRAL"

RH rotation	D	B	L	S	Z
T161.030.R	3	12	60	6	2
T161.035.R	3,5	14	60	6	2
T161.040.R	4	14	60	6	2
T161.045.R	4,5	16	60	6	2
T161.050.R	5	17	60	6	2

SOLID CARBIDE SPIRAL CUTTERS, FINISH STYLE S=8 Z=2

ART. T162

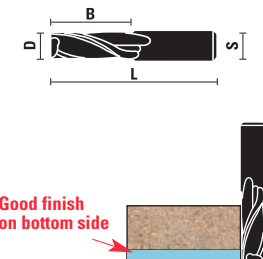

- Can also be used on portable routers
- Right-hand rotation with "UP CUT SPIRAL"

RH rotation	D	B	L	S	Z
T162.030.R	3	12	60	8	2
T162.040.R	4	14	60	8	2
T162.050.R	5	17	60	8	2
T162.060.R	6	22	70	8	2
T162.070.R	7	32	80	8	2

SOLID CARBIDE SPIRAL CUTTERS, FINISH STYLE S=8 Z=2

ART. T163

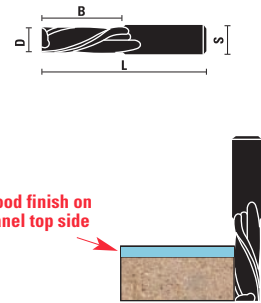

- Can also be used on portable routers
- Right-hand rotation with "DOWN CUT SPIRAL"

RH rotation	D	B	L	S	Z
T163.030.R	3	12	60	8	2
T163.040.R	4	14	60	8	2
T163.050.R	5	17	60	8	2
T163.060.R	6	22	70	8	2
T163.070.R	7	32	80	8	2

SOLID CARBIDE SPIRAL CUTTERS, ROUGHING STYLE Z=2

ART. T170

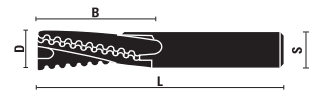

- Right-hand rotation with "UP CUT SPIRAL"
- Chip-breaker execution
- Z= 2 for the best chip removal

RH rotation	D	B	L	S	Z
T170.080.R	8	35	80	8	2
T170.100.R	10	35	80	10	2
T170.120.R	12	35	80	12	2
T170.121.R	12	45	90	12	2

Router bits with diameter from 12 mm, are produced with shank for Seeger retaining rings



SOLID CARBIDE SPIRAL CUTTERS, ROUGHING STYLE Z=2

ART. T171

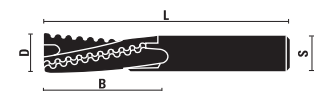

- Right-hand rotation with "DOWN CUT SPIRAL"
- Chip-breaker execution
- Z= 2 for the best chip removal

RH rotation	D	B	L	S	Z
T171.080.R	8	35	80	8	2
T171.100.R	10	35	80	10	2
T171.120.R	12	35	80	12	2

Router bits with diameter from 12 mm, are produced with shank for Seeger retaining rings



SOLID CARBIDE SPIRAL CUTTERS RADIUS STYLE Z=2
ART. T175

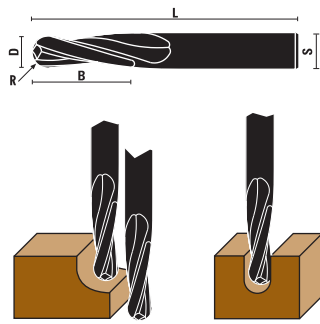

- Suitable for working plastic materials
- Right-hand rotation with "UP CUT SPIRAL"

RH rotation	D	R	B	L	Z
T175.030.R	3	1,5	12	50	2
T175.040.R	4	2	12	50	2
T175.060.R	6	3	22	60	2
T175.080.R	8	4	22	80	2
T175.100.R	10	5	35	80	2
T175.120.R	12	6	35	80	2
T175.160.R	16	8	55	100	2
T175.180.R	18	9	55	100	2
T175.200.R	20	10	55	100	2

Router bits with diameter from 12 mm, are produced with shank for Seeger retaining rings



THREE POINT DIGITAL CALIPER FOR CUTTERS Z=3
ART. C.DIGIT.Z3



- Measuring range: 4 mm ÷ 40,00 mm / 0,16" ÷ 1,73"
- Resolution: 0,01 mm/0,0005"
- Accuracy: ± 0,05 mm/± 0,002"
- Repeatability: 0,01 mm/0,0005"
- Maximum measurement speed: 1,5 m/s - 60 in/s
- Operating temperature: 0°C÷40°C
- Storage temperature: -10°C÷60°C
- Power: 1,5V SR44 (silver oxide cell) - 1 battery
- Battery life: 1 year continuous usage/ 3 years under normal operation

Caliper for measuring the diameter of router bits with three cutting edges (our items T143/T144, T153/T154 and any cutter Z=3)

Item	Measuring range
C.DIGIT.Z3	4÷40 mm

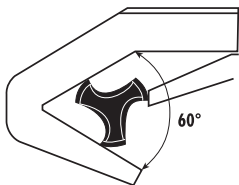

See the main catalogue KLEIN 14.A for more Spiral Router Bits, or contact us:

Tel: 01748 897170
E-Mail: colin@cptooling.co.uk
ian@cptooling.co.uk
Website: www.cptooling.co.uk

SOLID CARBIDE SPIRAL ROUTER BITS FINISH/ROUGHING STYLE
ART. T344



KleinDIA
coating for excellent performance

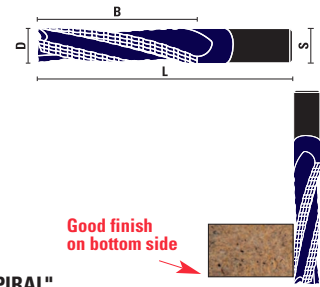

- Right-hand rotation with "UP CUT SPIRAL"
- To be used on machining centres, CNC routers and point to point machines
- For **softwood and hardwood, chipboard, MDF, HF, plywood, plastic coated, mineral materials (CORIAN® ecc.)**

RH rotation	D	B	L	Z
T344.080.RKD	8	30	80	2
T344.100.RKD	10	35	80	2
T344.120.RKD	12	35	80	3
T344.121.RKD	12	45	90	3
T344.140.RKD	14	55	110	3
T344.160.RKD	16	55	110	3
T344.161.RKD	16	75	130	3
T344.200.RKD	20	55	110	3
T344.201.RKD	20	75	130	3

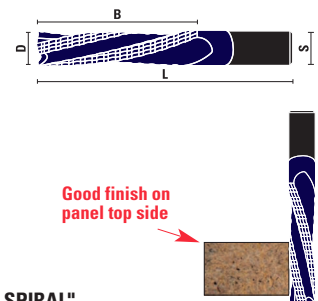

- Right-hand rotation with "DOWN CUT SPIRAL"
- To be used on machining centres, CNC routers and point to point machines
- For **softwood and hardwood, chipboard, MDF, HF, plywood, plastic coated, mineral materials (CORIAN® ecc.)**

RH rotation	D	B	L	Z
T354.100.RKD	10	35	80	2
T354.120.RKD	12	35	80	3
T354.160.RKD	16	55	110	3
T354.161.RKD	16	75	130	3
T354.200.RKD	20	55	110	3

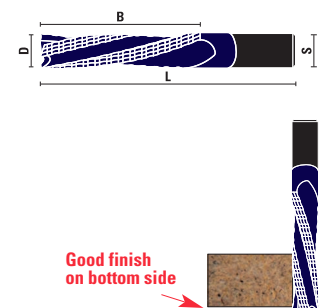

- Left-hand rotation with "UP CUT SPIRAL"
- To be used on machining centres, CNC routers and point to point machines
- For **softwood and hardwood, chipboard, MDF, HF, plywood, plastic coated, mineral materials (CORIAN® ecc.)**

LH rotation	D	B	L	Z
T354.100.LKD	10	35	80	2
T354.120.LKD	12	35	80	3
T354.160.LKD	16	55	110	3
T354.161.LKD	16	75	130	3
T354.200.LKD	20	55	110	3

SHRINK FIT COLLET CHUCKS HSK63F

ART. T120

HotBlock®

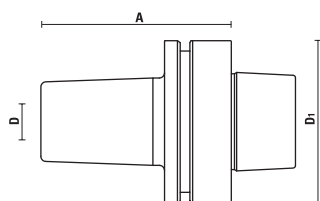

- Concentricity $\leq 0,003$ mm
- High precision tool holders guaranteed by thermally induced shrink fit
- High rigidity and balance for heavy CNC working
- For HS and HW cutting tool
- Balanced at G 2,5 x 24.000 RPM
- Right and left-hand rotation
- Cutting tool shank must have tolerance h6 with cylindrical shank (no flats)

Articolo/ Item	A	D1	D
T120.580.N	76	63	8
T120.600.N	76	63	10
T120.620.N	76	63	12
T120.627.N	76	63	1/2" - (12,7 mm)
T120.660.N	76	63	16
T120.695.N	76	63	3/4" - (19,05 mm)
T120.700.N	76	63	20
T120.750.N	76	63	25

SHRINK FIT UNIT

ART. K.START.2



- Heating time from 2 to 7 seconds
- Provided with inductor stop rings (6 to 12) + ($\varnothing 14$ to $\varnothing 20$) and chuck holder for HSK63F
- Heating located on the tool holder, no deterioration of the tool and tool holder
- Self-regulated power thanks to a microprocessor depending on parameters detected
- Inductor rotates 180° without disassembling
- Power supply 3x380/480V – 16A 50/60 Hz -14 kW
- Dimensions: L= 255 mm - D= 490 mm - H= 755 mm
- Weight (options excluded) 20 kgs

Item

K.START.2

COOLING UNIT WITH AIR FLOW

ART. K.FG500



- Air cooling unit for shrink fit collet chucks
- Cooling time from 1,30 minute to 3 minutes
- Provided with cooling stop rings (6 to 12) + ($\varnothing 14$ to $\varnothing 20$) and chuck holder for HSK63F
- Compressed air supply: 4-6 bars
- Dimensions: L= 220 mm - D= 190 mm - H= 615 mm
- Weight: 5 kgs

Item

K.FG500.1150



CALIPER FOR CUTTER Z=3

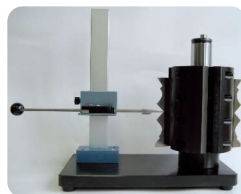

PRE SET P322



PRE SET LEADER

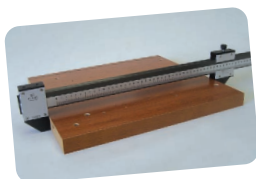

GAUGE FOR LINEAR MEASUREMENTS

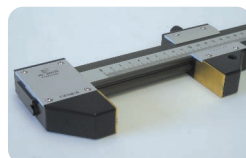

GAUGE FOR LINEAR MEASUREMENTS WITH STEEL PLATES



ANGOLFAST



DRILLING FOR CREMONE BOLTS



SPECIAL DEVICES FOR ANGULAR HINGES INSERTING



DRILLING JIG FOR MAKING HOLES FOR HINGE INSERTING - 32/90°



DRILLING JIG FOR MAKING HOLES FOR HINGE INSERTING



TRIMATIC FOR HINGES

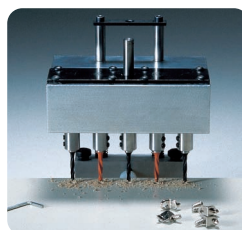

TRIMATIC 32

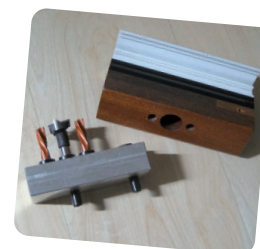

DRILLING OF WOOD AND PVC WINDOW FRAME TO FIT CREMONE BOLT

See the main catalogue KLEIN 14.A for more Products, or contact us:

Tel: 01748 897170
 E-Mail: colin@cptooling.co.uk
 ian@cptooling.co.uk
 Website: www.cptooling.co.uk



CP Tooling and Machinery Ltd
16 Harelands Court Yard Offices
Moor Road
Melsonby
Richmond
DL10 5NY

Tel. 01748 897170
info@cptooling.co.uk
www.cptooling.co.uk

Dealer