

Station	Easting	Northing	Level
Z1	311123.931	175746.876	43.156
Z2	311072.961	175743.546	43.985
Z3	311022.781	175755.414	43.337
Z4	311078.132	175770.432	44.255
Z5	311055.660	175821.595	41.656

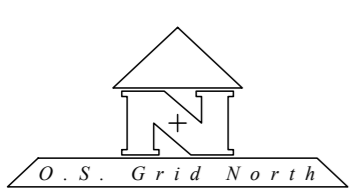
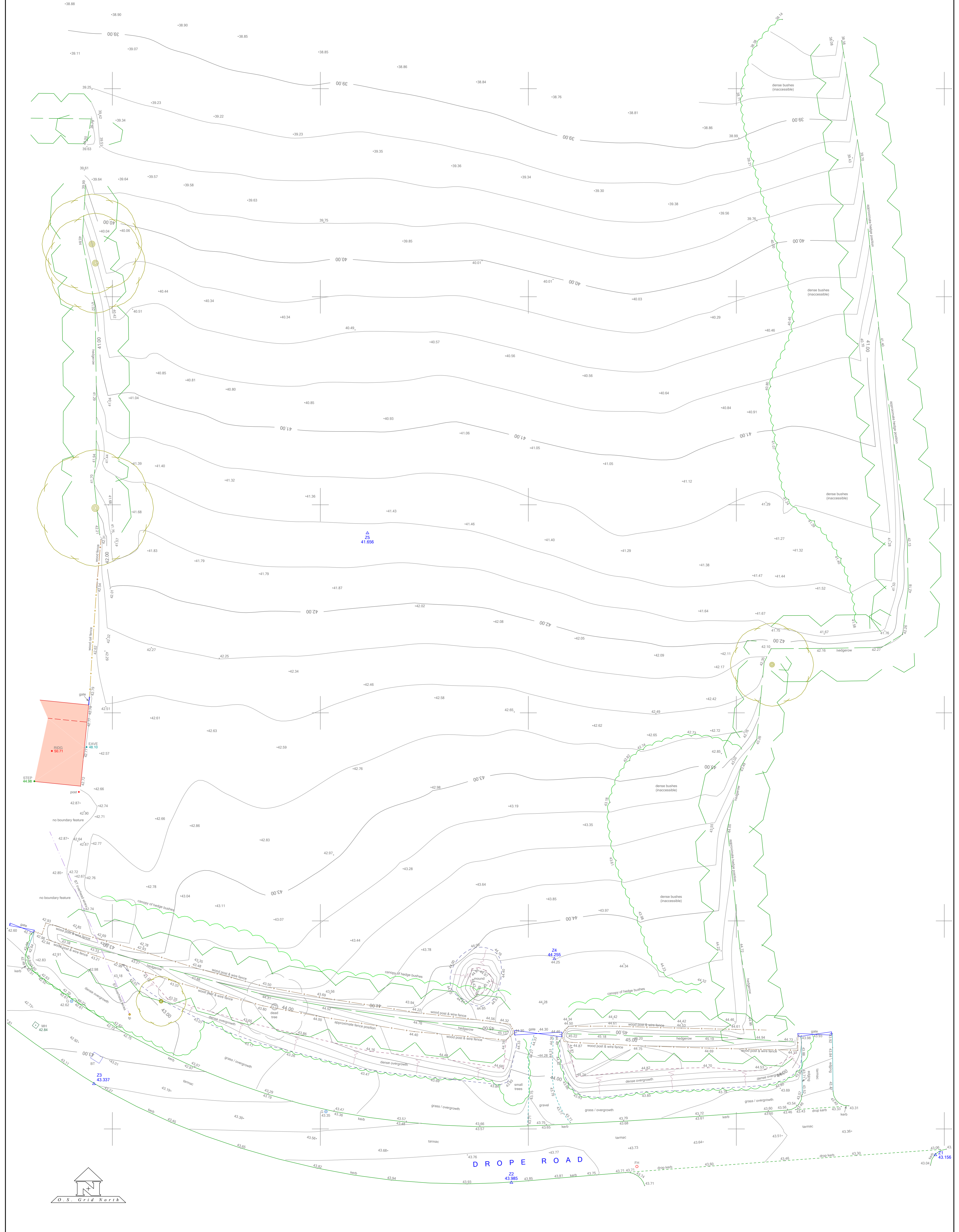

<p>General Survey Legend</p> <ul style="list-style-type: none"> Solid feature as annotated Opening in solid feature Edge of surface as annotated Change in surface gradient Top / foot of bank Slope indicator Hedge line Fulge line Water line Gate Electric line Telecom line Surface water sewer Foul water sewer Unknown sewer type Drain Electric lamp post Electric pole Gas valve Fire hydrant Gate Manhole Manhole Level as annotated Survey Station Deciduous tree Coniferous tree Bush Multi stem tree 	<p>Notes</p> <p>Survey Grid: Local Plane Grid related to O.S. National Grid at Survey Control Point Z2.</p> <p>Survey Datum: O.S. Datum Newlyn.</p> <p>North Point: O.S. Grid North.</p> <p>OSGB36 position/orientation and ODN level determined via Network RTK GNSS using the OSTN15/OSGM15 transformations. This survey must only be used in accordance with the instructions for correct use of this survey.</p>	<p>Title</p> <p>Land Off Drope Road, Drope, Vale Of Glamorgan</p> <p>Description</p> <p>TOPOGRAPHICAL SURVEY</p>	<p>Client</p> <p>Meadowlands Estate Limited</p> <p>Scale</p> <p>1:200 @ A1</p> <p>Date</p> <p>5 January 2022</p>	<p>Client</p> <p>IMM & SC</p> <p>Drawn</p> <p>SC</p>	<p>Zenith Land Surveys Ltd</p> <p>GPS Positioning, Topographical Land & Building Surveys</p> <p>Mill House, Old Caerphilly Road, Nantgaron, R.C.T., SF15 7TA, Telephone: 01443 845618 E-mail: office@zenithlandsurveys.com</p> <p>21673_A</p>
--	---	--	---	--	---