

# Case Study Campus Pictet de Rochemont



## Background:

The conurbation around Geneva is undergoing a stunning transformation. It is a re-invention of Urban and City spaces, conceptualised with the benefit of hindsight, and planned for a conscious future. The goal is to construct a symbiotic space for living and nature, with the benefits this will bring. At the heart of the Campus Pictet de Rochemont will be a showcase building.

A place to live, work and thrive in the knowledge that they are part of the remedy to the Global Warming Crises.

## The Problem:



The Pictet Group's ambition was to achieve Platinum rating for the new building. The highest level of SNBS, LEED and WELL certification possible.

Sustainability and economic viability for **SNBS**  
Environmental and energy protection for **LEED**  
Assessment of occupant well-being for **WELL**

It needed to be one of the **most environmentally conscious** buildings in Europe.



## The Solution?

**KOOLSHADE**  
The Ultimate In Passive Solar Shading

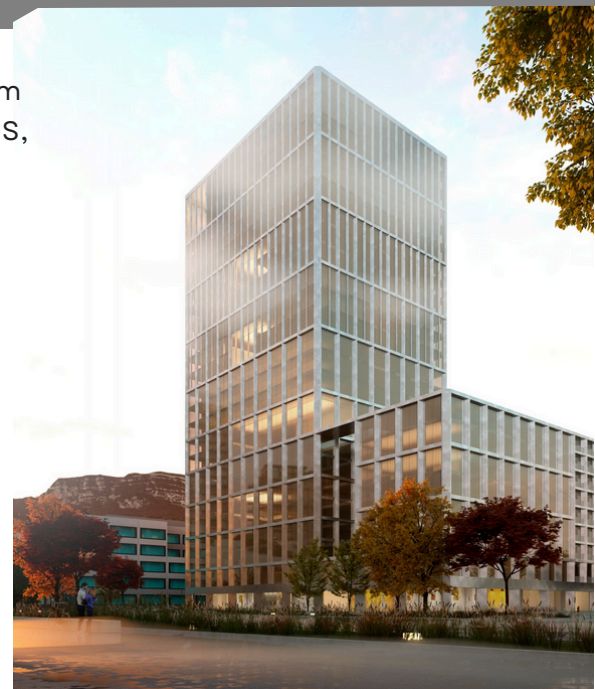

Innovation is expected when the Architect's name is revealed as Inès Lamunière, the founder and head of designlab-architecture, designers of exceptionally modern and sustainable, buildings.

From concept to design & specification, no leaf was left unturned in the search for a sustainable, carbon-neutral, environmentally sound construction. There are some material elements that are breaking new ground, not least of all, the dynamic, multifunctional building 'skin'.

The requirements were to:

- Provide effective Solar Shading
- Control Light & Glare
- Ensure energy saving
- Be manufactured from, and in, a sustainable way

The angular selective, 3D, Copper Bronze material will be added externally remove solar heat gain, allow ventilation to flow and remove glare whilst meeting LEED visual contact with the outside, criteria.



The building facade design is using a unique woven louvre material, known as KoolShade from SmartLouvre Technology.

It will bring immense benefits to the occupants of the building and to the environment itself.



#### STATS

- Inauguration of the building **2025**
- Office Space **55,000 m<sup>2</sup>**
- Number of workspaces **2,500**
- Area of KoolShade Fabric **12,000 m<sup>2</sup>**