

Case Study 1. Gable End, Private Customer - Woking



Background:

This new build house features impressive glazed sections to the front and rear elevations.

The architect was clearly driven by the aspirational light-flooded design trend associated with modern living.



The problem:

The internal temperatures were unbearable on sunny days and were hindering the owner's recovery from a health condition.

The home-owner sought the advice of an air cooling specialist to propose techniques which would have appropriate impact on the solar gains.



Results:

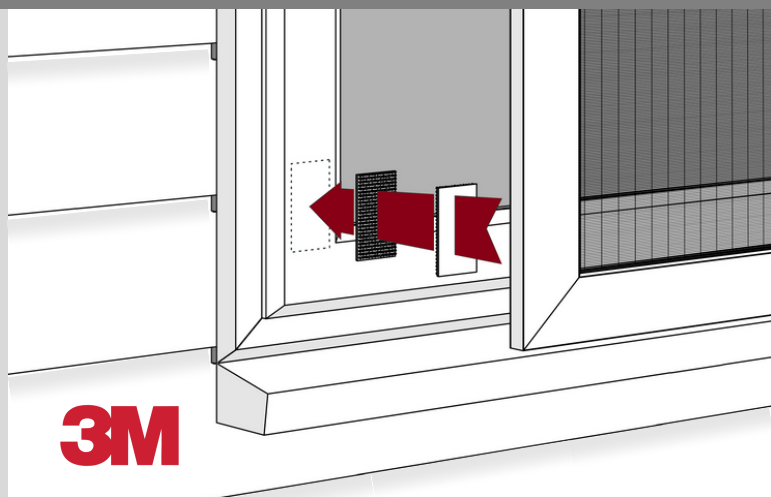

- Significant reduction in internal temperatures
- Balanced daylighting and full CRI
- Maintained ability to view out
- Compliant with all standards and regulations
- Easy to clean and durable

KOOLSHADE[®]
The Ultimate In Passive Solar Shading

With no mullions or brickwork to install the shading onto, 3M Dual Lock was used to fix to the window frames.



Prior to installation, the indoor temperatures had reached 30 degrees Celsius on a day when it was only 18 degrees outside.

With KoolShade®, the owner can now enjoy comfortable temperatures in her new home, as well as the views out through the screens' 80% open area and full natural daylight continuing to flood in.

The building construction posed a challenge since the window recess and building façade did not allow direct fix of the screens. However, the lightweight nature of the fabric and frames allow them to be fixed with an adhesive tape (3M Dual Lock) which also brings the benefit to the user of easy removal for cleaning (although the windows can be cleaned whilst the screens remain in-situ with a standard pressure washing process).



The micro fine louvres are now ensuring 87% of the sun's rays and its effects are blocked from reaching the glass and thereby radiating into the house. The owner quoted significant reduction in indoor temperatures. Prior to installation, the indoor temperatures had reached 30 degrees celsius on a day when it was only 18 degrees outside.

With Microlouvre Koolshade®, even when it was 24 degrees outside, the owner recorded an indoor temperature of just 22 degrees. The owner can now enjoy comfortable temperatures in her new home, as well as the views out through the screens' 80% open area and full natural daylight continuing to flood in.